

Rev	AWO #	Description	Date	Appr
-		RELEASED	5/23/05	

APPROVED: \_\_\_\_\_

DATE: \_\_\_\_\_ TITLE: \_\_\_\_\_

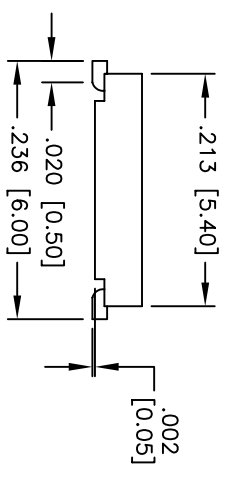
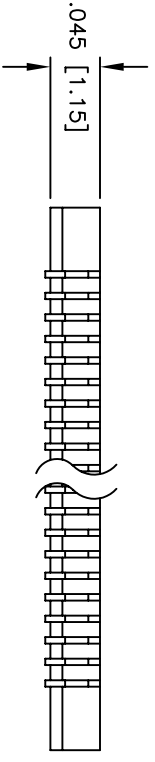
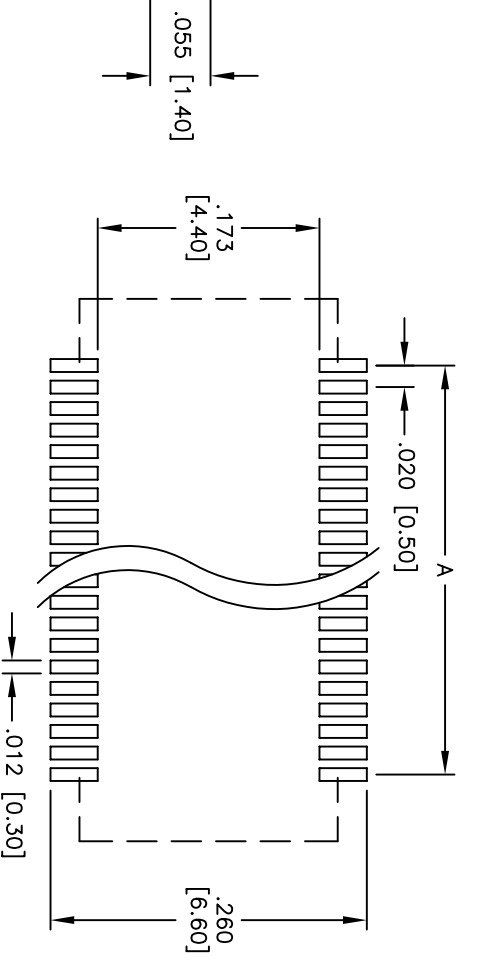
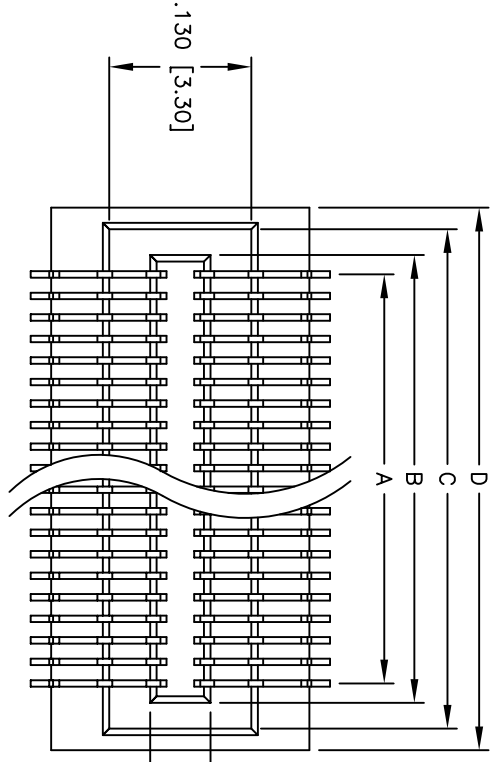

RECOMMENDED PCB LAYOUT

**SPECIFICATIONS:**

- Material: Insulator: LCP, glass reinforced, rated UL 94V-0
- Insulator color: Natural
- Contacts: Phosphor Bronze
- Plating: Gold flash over Nickel underplate overall
- Electrical: Operating voltage: 50 VAC max. Current rating: 0.3 Amps max. Contact resistance: 40 mohms max. initial Insulation resistance: 1,000 Mohms min. Dielectric withstanding voltage: 500 VAC for 1 minute
- Temperature Rating: Operating temperature: -65°C to +155°C
- Environmental: Lead free, RoHS compliant
- Recommended soldering temp: 260°C for 5 seconds

- Positions: 20, 28, 30, 40, 50, 60, 70, 80, & 90
- A = .020 [0.50] x (No. of Contacts - 1) + .035 [0.90]
  - B = .020 [0.50] x (No. of Contacts - 1) + .083 [2.10]
  - C = .020 [0.50] x (No. of Contacts - 1) + .122 [3.10]
  - D = .020 [0.50] x (No. of Contacts - 1) + .122 [3.10]

UNLESS OTHERWISE SPECIFIED ALL DIMENSIONS ARE INCHES [MM] TOLERANCES: EXCEPT AS NOTED INCHES

	INCHES	MILS	HOLE	DATE
.X	± .10	ØXX	± .10	
.XX	± .020	ØXXX	± .015	
.XXX	± .015	ØXXXX	± .010	

**ADAM TECH**

909 Railway Avenue, Union, NJ 07083  
Phone: 908-687-5000 Fax: 908-687-5710

.020 [0.50] BOARD TO BOARD PLUG  
SURFACE MOUNT

DRAWN	SS	5/23/05	SIZE	PART NO.	REV.
CHECKED			X	BB5-P-XX	-
APPROVED			REF:	SCALE: NTS	SHEET 1 OF 1