

Rev	AWO #	Description	Date	Appr
-		RELEASED	10/26/10	

APPROVED: _____

DATE: _____ TITLE: _____

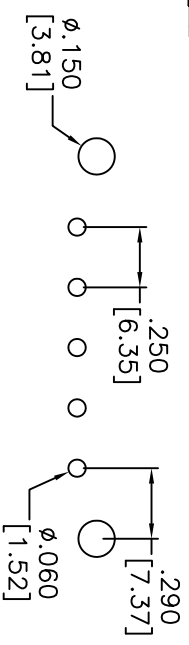
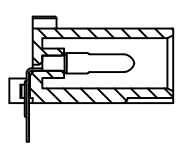
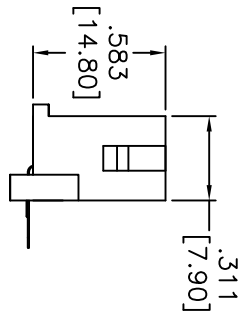
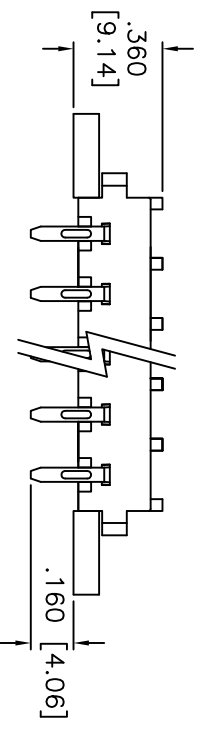
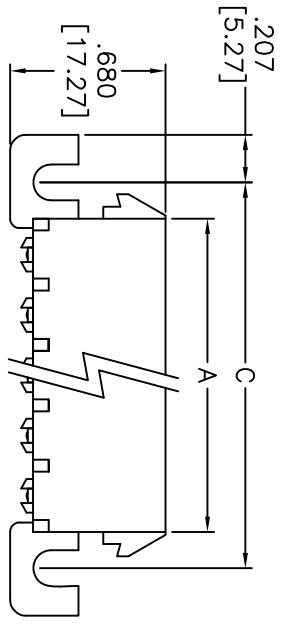
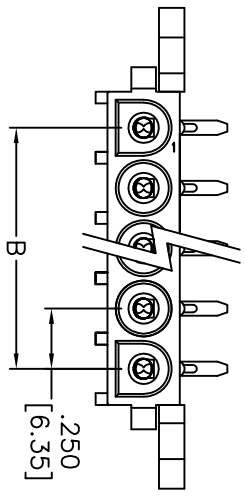

RECOMMENDED PCB LAYOUT

Positions: 2 thru 10

A = .250 [6.35] No. of Positions + .050 [1.27]

B = .250 [6.35] No. of Spaces

C = .250 [6.35] No. of Positions + .330 [8.38]

UNLESS OTHERWISE SPECIFIED
ALL DIMENSIONS ARE MM [INCHES]

TOLERANCES: EXCEPT AS NOTED

INCHES

.X ± .10 ØX ± .10

.XX ± .020 ØXX ± .015

.XXX ± .015 ØXXX ± .010

TITLE
WIRE TO BOARD HEADER, MALE WITH EARS
6.35MM, RIGHT ANGLE

909 Rahway Avenue, Union, NJ 07083
Phone: 908-687-5000 Fax: 908-687-5710

ADAM TECH

SPECIFICATIONS:

Material:

Insulator: Nylon 66, rated UL 94V-2

Insulator color: Natural

Contact: Phosphor Bronze, Tin plated

Electrical:

Operating voltage: 600 VAC max

Current rating: 13 Amps max.

Insulation resistance: 1000 Mohms min @ 500 VDC

Dielectric withstanding voltage: 5000 VAC for 1 minute

Mechanical:

Temperature Rating: Operating temperature: -55°C to +105°C

Environmental:

Lead free, RoHS compliant.

Recommended soldering temp: 235°C for 5 sec.



DRAWN	DY	10/26/10
CHECKED		
APPROVED		

SIZE	PART NO.	DME-M-XX-RIA-E	REV.
X			-
REF: S0004T	SCALE: NTS	SHEET 1 OF 1	