



Approvals

GAM T1 LISTED

Life expectancy

L-10 LIFE AT 40°C:
25 000 hours

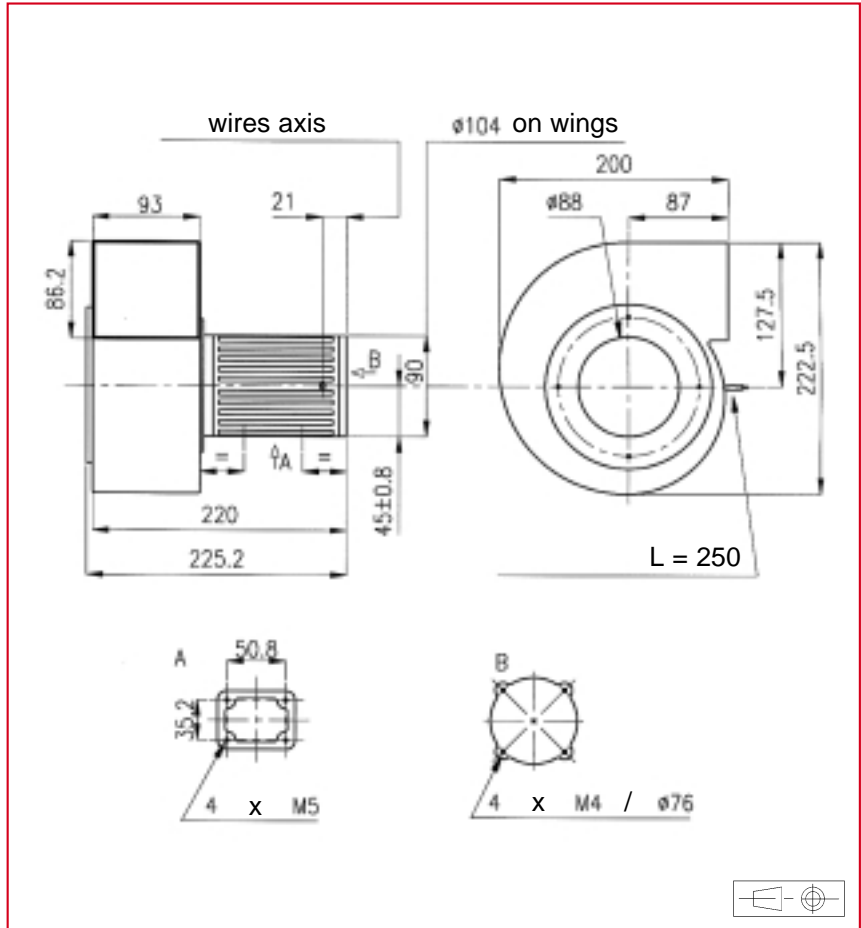
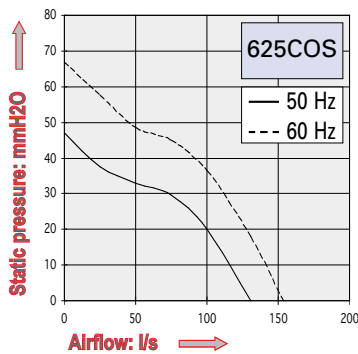

AC Motor

Housing material: steel plate
Wheel material: steel plate
Weight: 4,9 kg
Bearing system: ball bearings

Connection: flying leads

Available with:

- safety switch

| Part number | Nominal voltage | Airflow | Noise level | Nominal speed | Frequency | Phases | Capacitor (not included) | Input power | Nominal current | Starting current | Operating temperature | |
|---------------|-----------------|---------|-------------|---------------|-----------|--------|-----------------------------|-------------|-----------------|------------------|-----------------------|-------|
| | V | | | | | | | | | | l/s | dB(A) |
| 625COS016DC13 | 220 | 130 | 65 | 2850 | 50 | 3 | | 156 | 560 | 2100 | - 10 | 70 |
| | 380 | 130 | 65 | 2850 | 50 | 3 | | 155 | 520 | 2500 | - 10 | 70 |
| | 220 | 155 | 68 | 3300 | 60 | 3 | | 223 | 610 | 2000 | - 10 | 70 |
| | 380 | 155 | 68 | 3300 | 60 | 3 | | 210 | 460 | 2150 | - 10 | 70 |
| | 220 | 130 | 65 | 2850 | 50 | 1 | 6,9 | 156 | 1000 | 3600 | - 10 | 70 |
| | 380 | 130 | 65 | 2850 | 50 | 1 | 2,2 | 155 | 900 | 4250 | - 10 | 70 |
| | 220 | 155 | 68 | 3300 | 60 | 1 | 6,9 | 223 | 1100 | 3450 | - 10 | 70 |
| | 380 | 155 | 68 | 3300 | 60 | 1 | 2,2 | 210 | 800 | 3700 | - 10 | 70 |

Additional versions:

Salt spray protected - shock and vibration protected - marine specifications - wide temperature range

Accessories:

See pages: 157, 160 and 163