

Specification

Series	DOWN LIGHT HIGH POWER LED LAMP
Part Number	DONX-01X-X000-ND
Version	1.0 (Preliminary)
Date	12/14/2011



DOWN LIGHT HIGH POWER LED LAMP**Features**

- Input Voltage: AC 100 ~ 240V (Containing a transformer)
- Long life span
- Power 12W/15W/18W
- No ultraviolet light, infrared light spectrum
- CE and UL certified
- Indoor Lighting
- Warranty Period: 2 years

**Product Dimension**

Dimensions unit: mm

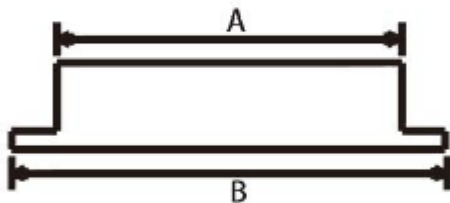

A=150/ B=180

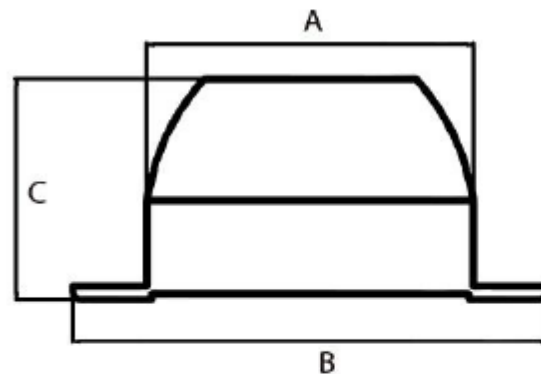

A=123.4/ B=179.4/ C=82.5

Specification

Part Number	DONX-012-3000-ND	DONX-012-6000-ND
Power	12W	
Input Voltage	AC 100 ~ 240V	
Front Lens Type	Glass	
Input Current	450mA	
Body Temp.	< 60 °C	
CCT	3000K Warm White	6000K Cool White
CRI	80	75
Luminous Flux	490lm	630lm
Life Time	Up to 20,000 hrs	
Net Weight	120g/430g	

Part Number	DONX-015-3000-ND	DONX-015-6000-ND
Power	15W	
Input Voltage	AC 100 ~ 240V	
Front Lens Type	Glass	
Input Current	450mA	
Body Temp.	< 60 °C	
CCT	3000K Warm White	6000K Cool White
CRI	80	75
Luminous Flux	630lm	810lm
Life	Up to 20,000 hrs	
Net Weight	120g/430g	

Part Number	DONX-018-3000-ND	DONX-018-6000-ND
Power	18W	
Input Voltage	AC 100 ~ 240V	
Front Lens Type	Glass	
Input Current	450mA	
Body Temp.	< 60 °C	
CCT	3000K Warm White	6000K Cool White
CRI	80	75
Luminous Flux	700lm	1080lm
Life	Up to 20,000 hrs	
Net Weight	120g/430g	

Part Number Coding:

DON X - XXX - XXXX - XX
 DON X - 012 - 3000 - ND
 1 2 3 4 5

Code	Description
1: Product Series	DON: Down Light
2: LED Configuration	U:350mA H:150mA K:20~60mA
3: Power Input (W)	012: 12W 015: 15W 018: 18W
4: CCT	3000: 3000K Warm White 6000: 6000K Cool White
5: Dimming Control	ND: Non Dimmable TD: Dimmable

Revision History

Description:	Revision #	Revision Date
New Release of DONX-01X-X000-ND Series	V1.0 (Preliminary)	12/14/2011

Disclaimer

QT-BRIGHTTEK reserves the right to make changes without further notice to any products herein to improve reliability, function or design. QT-BRIGHTTEK does not assume any liability arising out of the application or use of any product or circuit described herein; neither does it convey any license under its patent rights, nor the rights of others.

Life Support Policy

QT-BRIGHTTEK's products are not authorized for use as critical components in life support devices or systems without the express written approval of QT-BRIGHTTEK. As used herein:

1. Life support devices or systems are devices or systems which, (a) are intended for surgical implant into the body, or (b) support or sustain life, and (c) whose failure to perform when properly used in accordance with instructions for use provided in the labeling, can be reasonably expected to result in a significant injury of the user.
2. A critical component in any component of a life support device or system whose failure to perform can be reasonably expected to cause the failure of the life support device or system, or to affect its safety or effectiveness.

Product: High Power LED Down Light	Date: December 14, 2011	Page 4 of 4
P/N: DONX-01X-X000-ND	Version# 1.0 (Preliminary)	