



RLLH830-30-3

- Infrared Line Diode Laser Module
- 830 nm, 30 mW
- Fixed Focus
- Dimension: Ø14 x 45 mm



Description

RLLH830 series of Line Diode Laser Modules has been designed with emphasis on **superior beam quality**, and **reliable operation**. The modules body is made of black anodized aluminum, enclosing laser diode, lens, and driving electronics. RLLH830 series features a **cylinder glass lens optic** to generate a **line**. The supply voltage is specified with 3 **VDC**.

Specifications

Parameter	Min.	Values Typ.	Max.	Unit
Peak Wavelength	820	830	840	nm
Optical Output Power		30		mW
Laser Class		3B		
Operating Voltage		DC 3		V
Operating Current			80	mA
Control		APC		
Standard Operating Distance		500		mm
Focus		Fixed		
Beam Character		Line		
Output Aperture		Ø5		mm
Divergence		1.0		mrad
Line Thickness, @ 500 mm			1	mm
Optic		Cylinder Glass Lens		
Operating Temperature	-10		+40	°C
Storage Temperature	-30		+70	°C
Life Time	8000			hours
Material		black anodized aluminum		
Electrical Connection		connector plug		
Dimension (Dia. x W)		Ø14 x 45		mm
Weight		60		g



Outline Dimensions

RLDH830-30-3

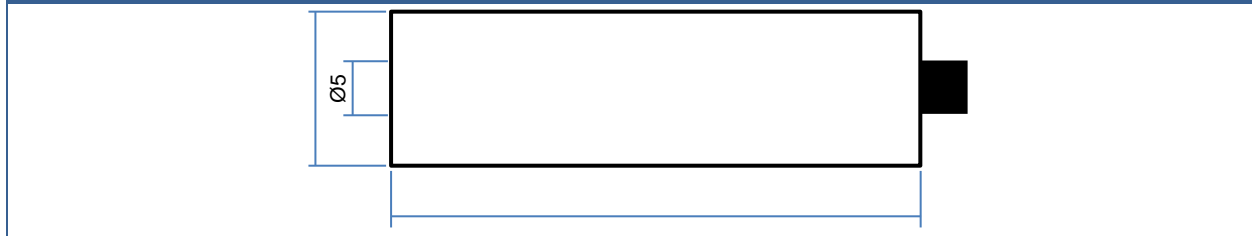

All Dimensions in mm

Electrical Connection

Connector plug



Precautions

Mounting Instruction:

In order to maintain lifetime and stability of the laser diode it is essential to provide efficient heat management. For long time stable operation proper contact between laser module and heat sink is mandatory.

Safety Advice:

This laser module emits highly concentrated invisible light which can be **hazardous to the human eye and skin**. It is classified as **CLASS 3B laser product** according to **IEC 60825-1** and **21 CFR Part 1040.10 Safety Standards**. Actual laser light emitted and precautions necessary strongly depend on mode of operation.