

**SCHEMATIC**

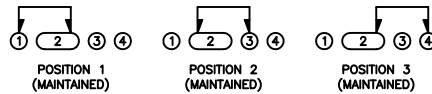

**SPECIFICATIONS**

FUNCTION:  
1P3T ON-ON-ON

RATINGS:  
0.5A 50VDC

CONTACT RESISTANCE:  
Initial: 30mΩ Max.

INSULATION RESISTANCE:  
500MΩ Min. at 500VDC

DIELECTRIC STRENGTH:  
500VAC For 1 Minute

ELECTRICAL LIFE:  
10,000 Cycles

APPROVALS:  
**RoHS LEAD FREE**  
COMPLIANT PROCESS COMPATIBLE

**MATERIALS**

BASE:  
Phenolic Board

COVER:  
Nickel Plated Steel

ACTUATOR:  
Polyoxymethylene (POM)

CONTACT:  
Silver Plated Brass

TERMINALS:  
Silver Plated Brass

**COLORS**

ACTUATOR:  
Black

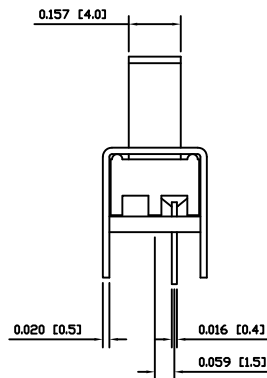
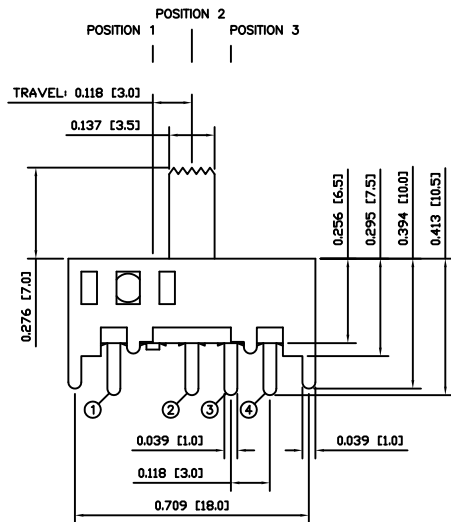

**SUGGESTED PCB LAYOUT**

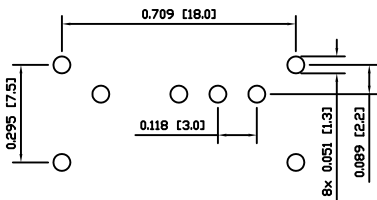

<p><b>LSS-130401B7</b></p>			
<p>DIMENSIONS INCHES [MILLIMETERS]</p>		<p>DRAWING NUMBER 03-LSS130401B7</p>	
<p>GENERAL TOLERANCES ±0.008 [±0.2] / ±1'</p>		<p>DATE SEPTEMBER 27, 2009</p>	
<p>SCALE DRAWING NOT TO SCALE</p>		<p>REVISION A</p>	

THE INFORMATION CONTAINED IN THIS DOCUMENT IS PROPRIETARY TO E-SWITCH AND IS NOT TO BE COPIED OR TRANSFERRED

A	INITIAL RELEASE	PCRD0115	09/09/27	CAB
REV.	DESCRIPTION	PCR	DATE	DRAWN BY