

Rev	AWO #	Description	Date	Appr
-		RELEASED	1/14/11	

APPROVED: \_\_\_\_\_  
 DATE: \_\_\_\_\_ TITLE: \_\_\_\_\_

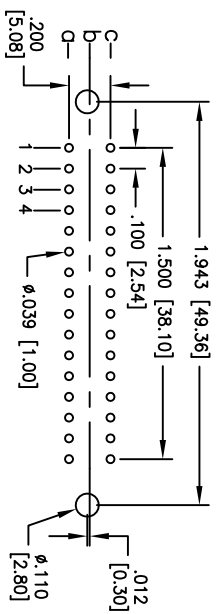
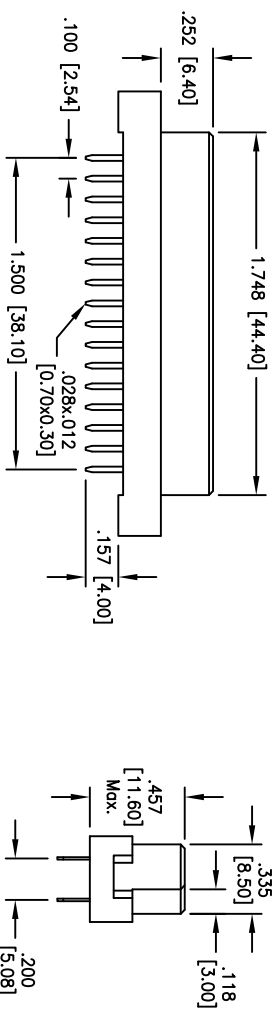
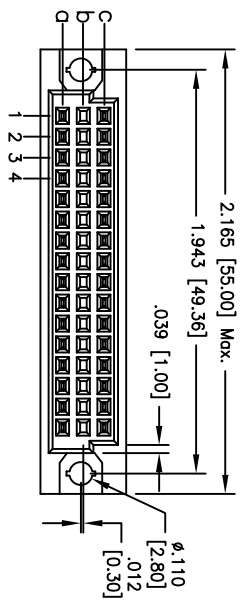

RECOMMENDED PCB LAYOUT

"X"	PLATING	CLASS
1	30 u" Gold	1
2	15 u" Gold	2
3	Gold Flash	3

**SPECIFICATIONS:**

**Material:**  
 Insulator: PBT, glass reinforced, rated UL 94V-0  
 Contacts: Phosphor Bronze  
**Plating:**  
 Gold over Nickel underplate on contact area,  
 Tin over Copper underplate on solder tails.  
 (See chart for thickness)

**Electrical:**

Current rating: 2 Amps max  
 Contact resistance: 50 mohms max  
 Insulation resistance: 1000 Mohms min  
 Dielectric withstanding voltage: 1000 VAC for 1 minute  
**Temperature Rating:**  
 Operating temperature: -55°C to +105°C  
 Environmental:  
 Lead free, RoHS compliant.  
 Recommended soldering temp: 235°C for 5 sec.



**ADAM TECH**

909 Railway Avenue, Union, NJ 07083  
 Phone: 908-687-5000 Fax: 908-687-5710

TITLE: DIN TYPE C FEMALE, 32 PINS LOADED  
 3 ROW STRAIGHT, ROW A & C LOADED

UNLESS OTHERWISE SPECIFIED ALL DIMENSIONS ARE MM [INCHES] TOLERANCES: EXCEPT AS NOTED		HOLE SIZE		DATE	
X	± .10	ØX	± .10		
.XX	± .020	ØXX	± .015		
.XXX	± .015	ØXXX	± .010		
APPROVALS		DATE		TITLE	
DRAWN	AY	1/14/11		DIN TYPE C FEMALE, 32 PINS LOADED	
CHECKED	JL	1/14/11		3 ROW STRAIGHT, ROW A & C LOADED	
APPROVED		SIZE	PART NO.	SCALE:	REV.
		X	DIN-32FS-S32-A1CX	NTS	-
		REF:	S00098T	SHEET	1 OF 1