

SCHEMATIC

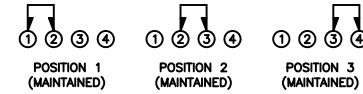

SPECIFICATIONS

FUNCTION:
1P3T ON-ON-ON

RATINGS:
0.5A 50VDC

CONTACT RESISTANCE:
Initial: 30mΩ Max.

INSULATION RESISTANCE:
500MΩ Min. at 500VDC

DIELECTRIC STRENGTH:
500VAC For 1 Minute

ELECTRICAL LIFE:
10,000 Cycles

APPROVALS:
RoHS LEAD FREE
COMPLIANT PROCESS COMPATIBLE

MATERIALS

BASE:
Phenolic Board

COVER:
Nickel Plated Steel

ACTUATOR:
Polyoxymethylene (POM)

CONTACT:
Silver Plated Steel Ball

TERMINALS:
Silver Plated Brass

COLORS

ACTUATOR:
Black

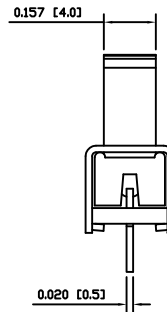
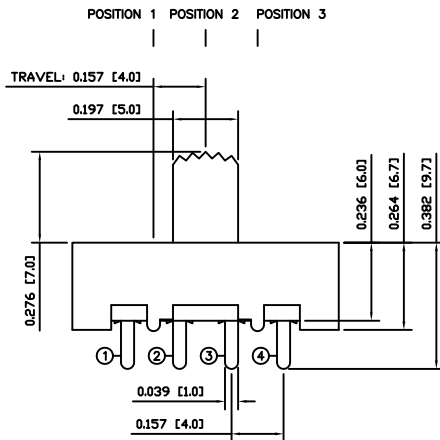

SUGGESTED PCB LAYOUT

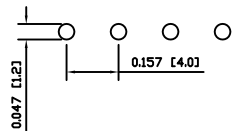

LSS-130501A7

DIMENSIONS		INCHES [MILLIMETERS]		DRAWING NUMBER		DATE		REVISION	
GENERAL TOLERANCES		±0.008 [±0.2] / ±1'		03-LSS130501A7		SEPTEMBER 27, 2009		A	
SCALE	PROJECTION	DRAWING NOT TO SCALE		DRAWING NUMBER		DATE		REVISION	
				03-LSS130501A7		SEPTEMBER 27, 2009		A	

THE INFORMATION CONTAINED IN THIS DOCUMENT IS PROPRIETARY TO E-SWITCH AND IS NOT TO BE COPIED OR TRANSFERRED

A	INITIAL RELEASE	PCRD0115	09/09/27	CAB
REV.	DESCRIPTION	PCR	DATE	DRAWN BY