

Miniature Threaded Coaxial Capacitors

DCT

Ordering Information

e.g. **DCT 105N**

Blank - Tin finish
S - Silver

Capacitance, e.g.
100 pf = 100P
2700 pf = 02N7

Circuit Diagram

Voltage Rating

DCT# _ _ _ _			
#	-55°C to +85°C V d.c.	-55°C to +125°C V d.c.	-55°C to +125°C V a.c. 400 Hz
1	50	43	—
2	70	60	—
4	100	87	62
41	125	105	—
5	150	130	90
51	175	150	—
7	300	260	185

Environmental Classification 55/125/56

For Test Conditions see page 63

Case Dimensions

All dimensions maximum unless otherwise stated, in millimetres.

DCT _ # # _ _											
# #	L1 Max.	L2 Max.	L3 +0 -1.5	L4 +0 -1.5	L5 Nom.	A/F Max.	D Nom.	Thread	Mounting Style	Max. Panel Thickness	
05	7.8	10.1	3.5	5.8	1.25	4.05	0.8	4-40 UNC 2A	A or B	2.0	
06	12.5	15	3.0	5.8	1.25	4.05	0.8	M3 x 0.5	A or B	2.0	
08	8.3	12.6	3.5	7.0	1.25	5.0	0.8	8-32 UNC 2A	A or B	3.0	
09	9.2	23.9	5.0	8.0	1.5	5.0	0.8	12-32 UNEF 2A	A or B	3.0	
22	9.8	12.3	5.0	7.4	1.5	8.17	1.0	12-32 UNEF 2A	A or B	3.0	

Characteristics

Part Number	Rated Current (Amps)	Min. Cap. (nF)	Min IR (GΩ)	Typical Insertion Loss (db) at Full Load Current -55°C to +125°C per BS 6299							
				50 kHz	100 kHz	300 kHz	1 MHz	10 MHz	100 MHz	1 GHz	10 GHz
DCT105N-45N0	10	45.0	5	-	-	4	14	30	45	55	60
DCT108N-50N0	10	50	5	-	-	6	15	32	45	60	60
DCT109N-50N0	10	50	5	-	-	6	15	32	45	60	60
DCT122P-01U0	15	1000	0.2	15	21	31	40	52	70	70	70
DCT205N-100P	10	0.1	10	-	-	-	-	-	2	17	28
DCT205N-500P	10	0.5	10	-	-	-	-	-	13	30	40
DCT205N-01N2	10	1.2	10	-	-	-	-	3	20	37	45
DCT205N-02N7	10	2.7	10	-	-	-	-	9	25	40	50
DCT205N-05N0	10	5.0	10	-	-	-	-	14	30	45	55
DCT208N-120N	10	120	1	-	-	12	21	40	55	55	55
DCT209N-120N	10	120	1	-	-	12	21	40	55	55	55
DCT222P-750N	15	750	0.3	12	18	27	37	51	61	65	65
DCT405N-15N0	10	15.0	5	-	-	-	5	20	35	50	60
DCT408N-80N0	10	80	2	-	-	7	19	37	51	55	55
DCT409N-80N0	10	80	2	-	-	7	19	37	51	55	55
DCT4122P-300N	15	300	1	5	10	20	30	45	55	60	60
DCT505N-100P	10	0.1	5	-	-	-	-	-	2	17	28
DCT505N-500P	10	0.5	5	-	-	-	-	-	13	30	40
DCT505N-01N2	10	1.2	5	-	-	-	-	3	20	37	45
DCT505N-02N7	10	2.7	5	-	-	-	-	9	25	40	50
DCT5122P-100N	15	100	2	-	-	7	19	37	57	55	55
DCT705N-100P	10	0.1	5	-	-	-	-	-	2	17	28
DCT705N-500P	10	0.5	5	-	-	-	-	-	13	30	40
DCT705N-01N2	10	1.2	5	-	-	-	-	3	20	35	45

Note: All units in the 05 case are also available in case size 06

Miniature Threaded Coaxial Capacitors

DCT

Ordering Information

e.g. **DCT418N**

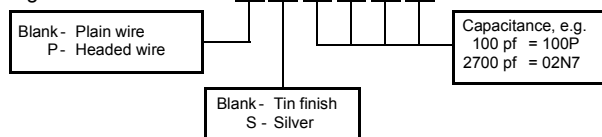

Circuit Diagram

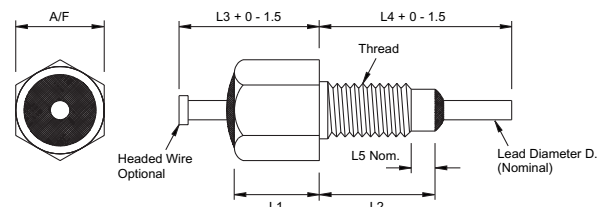
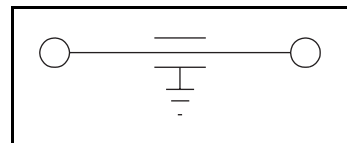

Voltage Rating

DCT# _ _ _ _			
#	-55°C to +85°C V d.c.	-55°C to +125°C V d.c.	-55°C to +125°C V a.c. 400 Hz
4	100	87	62
6	200	175	125

For Test Conditions see page 63

Case Dimensions

This range is also available as L-style filters by the inclusion of inductance within the thread area. To order, amend code from DCT to DLT.

All dimensions maximum unless otherwise stated, in millimetres.

Environmental Classification

55/125/56

DCT _ # # _ _ and DLT _ # # _ _												
# #	L1 Max.	L2 Max.	L3 Pin	L3 Headed Leads	L4 Pins	L4 Headed Leads	L5 Nom.	A/F	D Nom.	Thread	Mounting Style	Max Panel Thickness
07	7 Min	9	23 Min	25	3.2	5.9	1.25	4.05	0.7	6-32 UNC 2A	A or B	2.0
18	32 Min	13.4	34 Min	19.8	5.0	6.5	-	6.4	0.9	M5 x 0.8	A or B	2.5
19	32 Min	13.4	34 Min	19.8	5.0	6.5	-	6.4	0.9	2BA	A or B	2.5
55	7	—	10	—	3.5	5.8	1.25	4.05	0.6	4-40 UNC 2A	A or B	1.5

Characteristics

Part Number	Rated Current (Amps)	Min. Cap. (nF)	Min IR (GΩ)	Typical Insertion Loss (db) at Full Load Current -55°C to +125°C			
				10 MHz	100 MHz	1 GHz	10 GHz
DCT418N-22P0	10	0.022	10	-	1	6	33
DTC419N-22P0	10	0.022	10	-	1	6	33
DCT418N-47P0	10	0.047	10	-	2	11	35
DCT419N-47P0	10	0.047	10	-	2	11	35
DCT418N-100P	10	0.1	10	-	4	19	37
DCT419N-100P	10	0.1	10	-	4	19	37
DCT418N-330P	10	0.33	10	-	11	32	47
DCT419N-330P	10	0.33	10	-	11	32	47
DCT418N-470P	10	0.47	10	1	14	36	50
DCT419N-470P	10	0.47	10	1	14	36	50
DCT418N-680P	10	0.68	10	2	17	38	54
DCT419N-680P	10	0.68	10	2	17	38	54
DCT418N-01N0	10	1.0	10	4	20	39	60
DCT419N-01N0	10	1.0	10	4	20	39	60
DCT418N-04N7	10	4.7	5	15	33	45	62
DCT419N-04N7	10	4.7	5	15	33	45	62
DCT418N-10N0	10	10.0	5	21	40	48	62
DCT419N-10N0	10	10.0	5	21	40	48	62
DCT418N-22N0	10	22.0	5	28	47	55	65
DCT419N-22N0	10	22.0	5	28	47	55	65
DCT418N-47N0	10	47.0	5	34	53	62	65
DCT419N-47N0	10	47.0	5	34	53	62	65

Part Number	Rated Current (Amps)	Min. Cap. (nF)	Min IR (GΩ)	Typical Insertion Loss (db) at Full Load Current -55°C to +125°C			
				10 MHz	100 MHz	1 GHz	10 GHz
DCT418N-100N	10	100.0	5	41	60	65	65
DCT419N-100N	10	100.0	5	41	60	65	65
DCT407N-27N0	10	27.0	2.5	30	45	60	65
DCT407N-50N0	10	50.0	2.5	34	53	62	65
DCT607N-330P	10	0.33	5	-	11	32	47
DCT607N-680P	10	0.68	5	2	17	38	54
DCT607N-01N0	10	1.0	5	4	20	39	60
DCT607N-04N7	10	4.7	5	15	33	45	62
DCT607N-10N0	10	10.0	5	21	40	48	62

Note: All units in the 07 case are also available in case size 55