

### TYPE Q/2 FEMALE CONNECTOR SERIES 21



#### PHYSICAL PROPERTIES

**INSULATION MATERIAL:** Glass filled thermoplastic rated UL 94V-0

**COLOR:** Gray

**CONTACTS:** Copper alloy, nickel plate overall, gold finish in contact zone. Tin/lead on solder tails, tin/lead or gold on posts.

#### ELECTRICAL PROPERTIES

**CURRENT RATING:** 2 Amps per pin

**INSULATION RESISTANCE:**  $>1 \times 10^9$  Ohms

**DIELECTRIC STRENGTH:**  $>500$  VDC at sea level

#### ENVIRONMENTAL PROPERTIES

**TEMPERATURE RATING:** -55°C TO 125°C

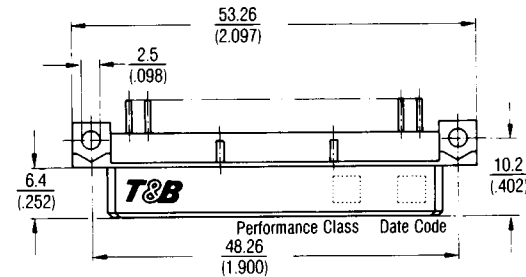
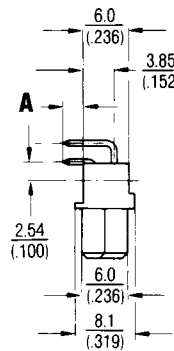
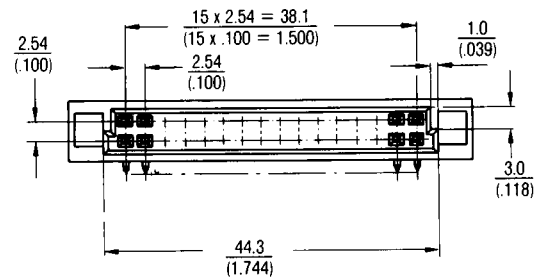
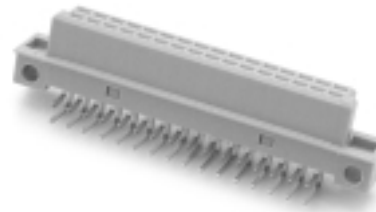

X	PERFORMANCE LEVEL
1	level 1 - 500 mating cycles
8	level 2 - 400 mating cycles
4	level 3 - 50 mating cycles

#### Recommended Printed Circuit Board Layout

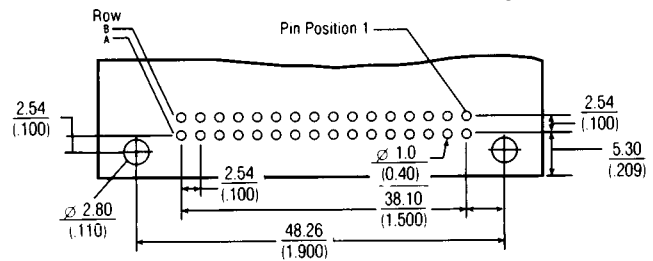

#### Ordering Information

NO. OF CONTACTS	CONTACT LOADING	CATALOG NO. SPECIFY X	TERMINATION STYLE	MM (INCHES)
32	a, b 1, 2, 3 -16	212-33230-305X	A = 2.9	
			(.114)	
16	a, b 2, 4, 6 -16	212-31620-315X	A = 3.7	
32	a, b 1, 2, 3 -16	212-33230-315X	(.146)	

**Solder Post**  
0.6 x 0.6  
(.024 x .024)