

REVISION RECORD				
REV	ECO	DESCRIPTION	DRFT	CHKD

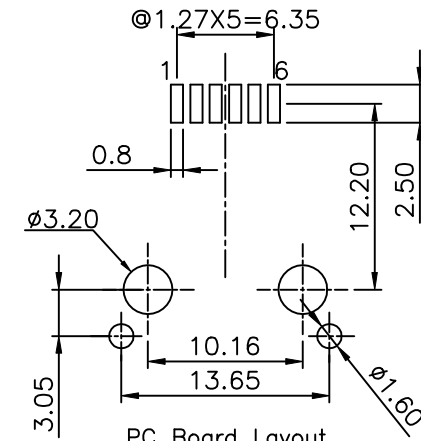
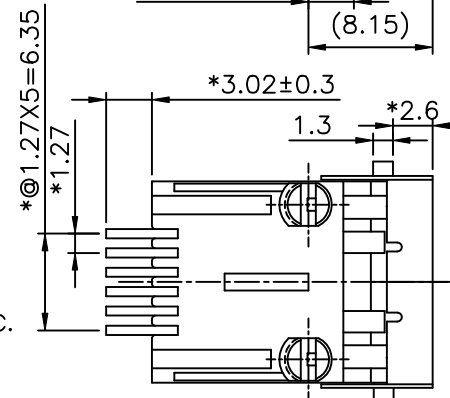
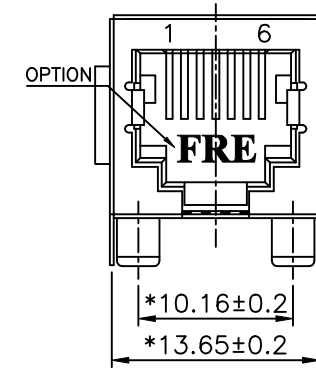
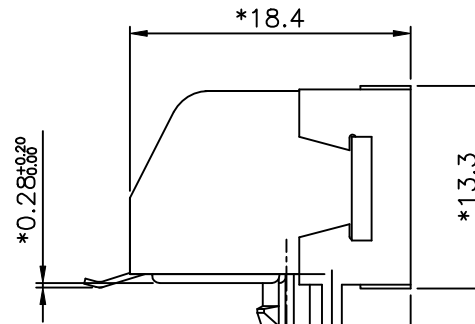
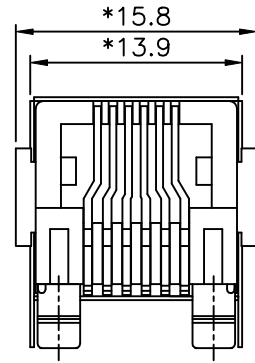

PC Board Layout
Component Side Shown

NOTES:

ELECTRICAL:

- VOLTAGE RATING : 125 VAC RMS.
- CURRENT RATING : 1.5 AMP.
- CONTACT RESISTANCE : 35 MILLIOHMS MAX.
- INSULATION RESISTANCE: 1000 MEGOHMS MIN @ 500 VDC.
- DIELECTRIC STRENGTH : 1000 VAC RMS 60Hz, 1MIN.

MECHANICAL:

- HOUSING MATERIAL : FR52 BK UL94V-0.
- CONTACT MATERIAL : PHOSPHOR BRONZE t=0.35mm.
- PLATING : CONTACT GOLD PLATING OVER NICKEL.
- OPERATING LIFE : 750 CYCLES MIN.
- PCB RETENTION PRE-SOLDER : 1 LB MIN.
- PCB RETENTION POST-SOLDER: 10 LBS MIN.

ENVIRONMENTAL:

- STORAGE : -40°C TO +85°C.
- OPERATION: 0°C TO 70°C.
- WAVE SOLDERING TEMPERATURE: 255°C ~265°C (5~10 SECONDS).

MATES WITH MODULAR PLUG CONFORMING TO
FCC PART 68, SUBPART F.

CUL FILE NO. E163191

RoHS P/N: E626X-0504XX-L

NO. OF CONTACT	1- 3u"	2- 6u"
2-2C	3-15u"	4-30u"
4-4C	5-50u"	
6-6C		

- 1- W/ PANEL STOP,W/O KEY,W/O "FRE" LOGO
- A- W/ PANEL STOP,W/O KEY,W/ "FRE" LOGO

← MM (INCH) →		DFTO Yicun	DATE 12/22/05
TOLERANCES EXCEPT AS NOTED		CHKDANKUE	DATE2005/12/22
		MFO	DATE
		APPVLLUSHENG	DATE2005/12/22
MM	±		
.0	±0.20		
.00	±0.15		
.000	±0.075		
ANGLES ±			
THIRD ANGLE PROJECTION			
		MATERIAL :	
		QTY :	
		FINISH :	
		SCALE : 3:1	

FULL RISE ELECTRONIC CO., LTD

TITLE
AMP L/P 6P SMT TYPE

DRAWING NO. GE623002-LA

/PART NO. SEE NOTE

SIZE
A3

REV
0

DO NOT SCALE DRAWING

SHEET X OF Y