

GSD

M49142/08-0006

REVISIONS

ISSUE	CHANGES
4	CN 34823 C REDRAWN JCA 08/04/93

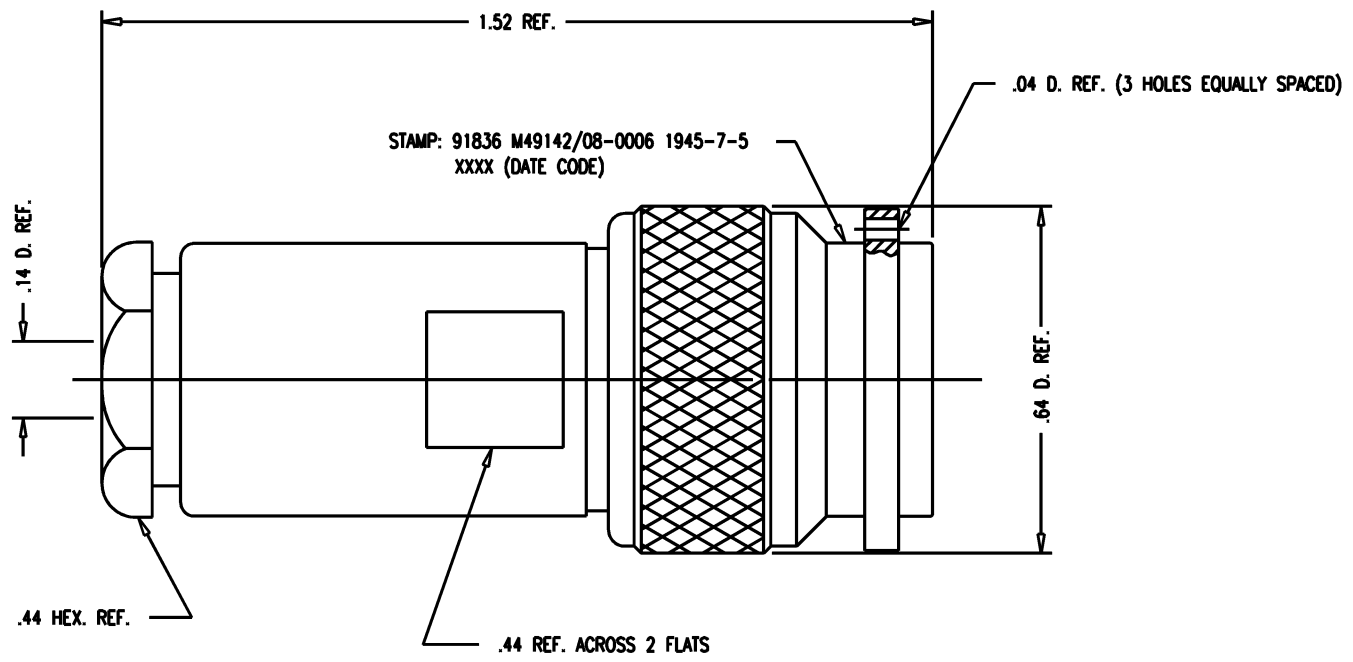

- NOTES:**
- FOR USE WITH M17/176-00002 CABLE.
 - FOR CABLING INSTRUCTIONS SEE 3-395.
 - INTERFACE PER MIL-STD-348, FIG. 202-1.
 - MATERIALS:**
 - INSULATORS-TEFLON, ASTM-D-1457
 - GASKET } SILICONE RUBBER, ZZ-R-765
 - O-RING }
 - INTERMEDIATE CONTACT } BERYLLIUM COPPER, ASTM-B-196
 - OUTER CONTACT }
 - ALL OTHER METAL PARTS-BRASS, ASTM-B16
 - FINISHES:**
 - CENTER CONTACT-GOLD PLATE PER MIL-C-45204
 - ALL OTHER METAL PARTS-SILVER PLATE PER QQ-S-365
 - ELECTRICAL CHARACTERISTICS:**
 - WORKING VOLTAGE-400 VRMS

JCA4189

SCALE 4:1

APPROX SURFACE AREA

1945-7-5

USED ON

REF:

PLUG, TRT

DRAWN	JCA	DATE	08/04/93
-------	-----	------	----------

DESIGN	MJB	DATE	08/05/93
--------	-----	------	----------

APPR.		DATE	
-------	--	------	--

KINGS
ELECTRONICS CO., INC.
TUCKAHOE, NEW YORK 10707

M49142/08-0006

GSD