

# GSD

M39012/01-0101

**REVISIONS**

ISSUE	CHANGES	
3	CN LNM	32243 A 06/01/90

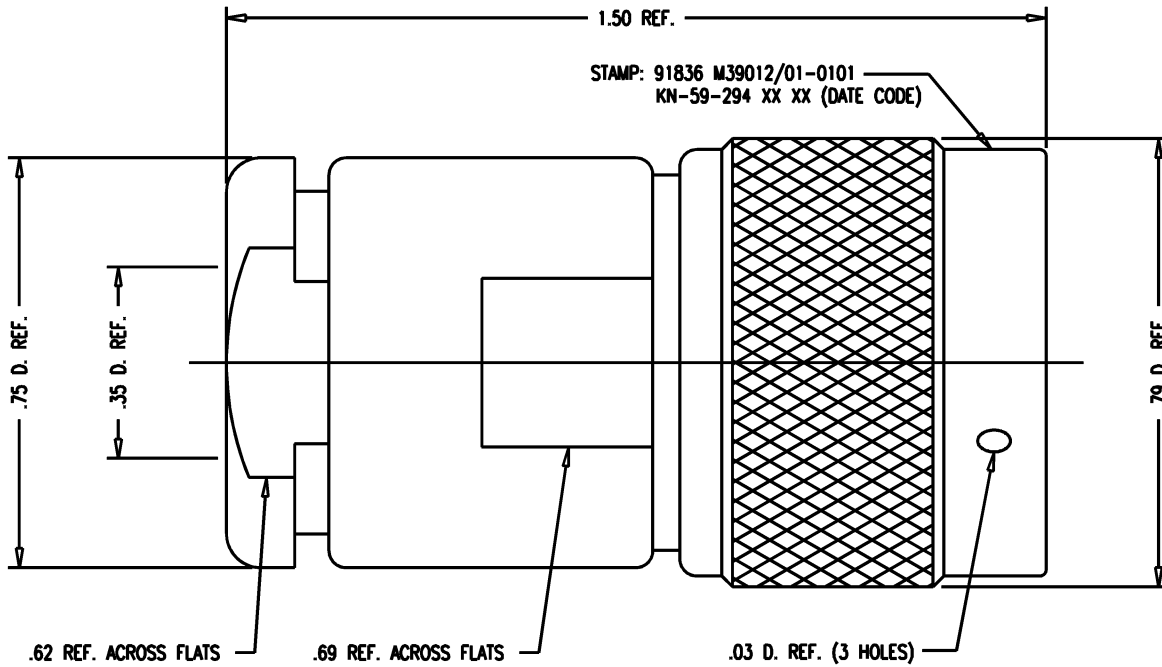

**NOTES:**

- FOR USE WITH RG-6, 212 & 222/U CABLE GROUPS.
- FOR CABLING INSTRUCTIONS SEE CP-1016.
- MATERIALS:  
 INSULATORS: TEFLON, ASTM-D-1457  
 GASKET: SIL. RUB., ZZ-R-765  
 OUTER CONTACT: PHOS. BRONZE, QQ-B-750  
 ALL OTHER PARTS: BRASS, ASTM-B16
- FINISHES:  
 CENTER CONTACT: HARD GOLD PLATE PER MIL-G-45204  
 ALL OTHER METAL PARTS: SILVER PLATE PER QQ-S-365
- ELECTRICAL CHARACTERISTICS:  
 NOMINAL IMPEDANCE: 50 OHMS  
 VOLTAGE RATING: 1000 VRMS  
 FREQUENCY RANGE: DC TO 11 GHz

JCA2597

SCALE 4:1

APPROX SURFACE AREA

KN-59-294

USED ON

REF:

PLUG, N

DRAWN JCA DATE 03/23/92

DESIGN MJB DATE 03/23/92

APPR. DATE

**KINGS**  
ELECTRONICS CO., INC.  
TUCKAHOE, NEW YORK 10707

# GSD

M39012/01-0101