

| | | | | |
|--------|------------|---------------|---------------------|----------|
| REV. - | AUTH. R.L. | DATE 10/15/04 | INITIAL RELEASE | APPROVED |
| REV. A | AUTH. M.R. | DATE 11/10/04 | ADDED TOOLING HOLES | APPROVED |

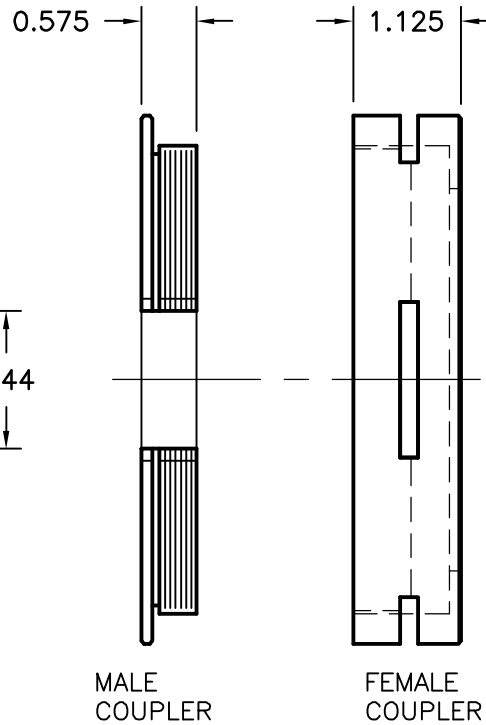
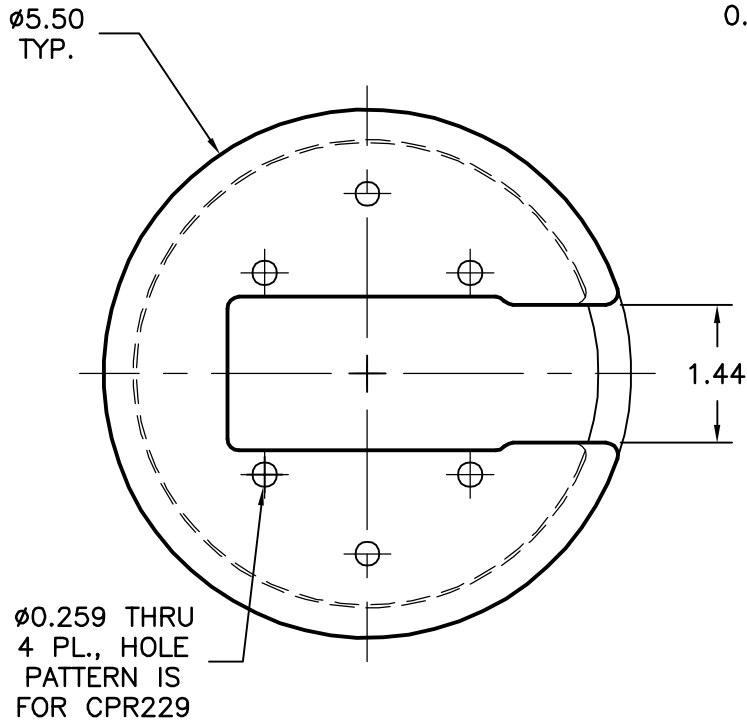

MAX. COMBINED
FLANGE THICKNESS
= 0.750"

NOTES:

1. THIS ASSY. FOR USE WITH CPR229-F/G FLANGES.
2. ASSEMBLY REQUIRES NYLON HARDWARE, TRIMMED TO LENGTH, SO AS NOT TO PROTRUDE PAST FACE OF TAPPED HOLE FLANGE.

| | | | | |
|---|------------------------|---|--|-------------------|
| MATERIAL ALUM. | TREATMENT - | DRAWN R. LYNCH | DATE 10/15/04 | |
| FINISH BLACK ANODIZE | MOD. NO. QD-229 | CHECKED | DATE | |
| OUTLINE, WR229 QUICK DISCONNECT | | APPROVED | DATE | |
| | | CAGE CODE: OR8N4 | DO NOT SCALE DWG | |
| ADVANCED TECHNICAL MATERIALS, INC. 49 RIDER AVE., PATCHOGUE N.Y. 11772 TEL: (631) 289-0363 FAX: (631) 289-0358 http://www.atmmicrowave.com | | UNLESS OTHERWISE NOTED DIMENSIONS ARE IN INCHES TOLERANCES ARE: | FRACTIONS ±1/64 DECIMALS ±.01 ANGLES ±1/2° | SHEET. 1/1 |
| PROPRIETARY NOTICE: THE INFORMATION IN THIS DRAWING IS PROPRIETARY AND SHALL NOT BE USED OR DISCLOSED WITHOUT THE PRIOR WRITTEN CONSENT OF ATM, INC. | | SCALE 1 : 2 | DWG. NO. 7036 | REV. A |
| | | | | |