



# TAI-SAW TECHNOLOGY CO., LTD.

No. 3, Industrial 2nd Rd., Ping-Chen Industrial District,  
Taoyuan, 324, Taiwan, R.O.C.

TEL: 886-3-4690038 FAX: 886-3-4697532

E-mail: [tstsales@mail.taisaw.com](mailto:tstsales@mail.taisaw.com) Web: [www.taisaw.com](http://www.taisaw.com)

## Approval Sheet For Product Specification

Issued Date:

Product Name: Differential SAW Filter 1220 MHz

TST Parts No.:TA0269A

Customer Parts No.:\_\_\_\_\_

Company:_____
Division:_____
Approved by :_____
Date:_____

Checked by:\_\_\_\_\_ Andy Lee

Approval by:\_\_\_\_\_ Francis Chen

Date:\_\_\_\_\_ 2003/07/02



# TAI-SAW TECHNOLOGY CO., LTD.

No. 3, Industrial 2nd Rd., Ping-Chen Industrial District,  
Taoyuan, 324, Taiwan, R.O.C.

TEL: 886-3-4690038 FAX: 886-3-4697532

E-mail: [tstsales@mail.taisaw.com](mailto:tstsales@mail.taisaw.com) Web: [www.taisaw.com](http://www.taisaw.com)

## Differential SAW Filter 1220 MHz SMD 3X3mm

MODEL NO.: TA0269A

REV. NO.3

### A. MAXIMUM RATING:

1. Operating Temperature: -40°C ~ +85°C
2. Storage Temperature: -40°C ~ +85°C

RoHS Compliant  
Lead free  
Lead-free soldering

### B. Characteristics :

1. Balanced to Balanced operation
2. Terminating source impedance :  $Z_s = 200 \Omega$
3. Terminating load impedance :  $Z_L = 200 \Omega$

Characteristics	Value			Note
	Min.	Typ.	Max.	
Center frequency $F_C$ MHz	-	1220	-	-
Insertion loss( 1216~1224 MHz) I.L. dB	-	3.7	4.8	-
Ripple ( 1216~1224MHz) dB	-	0.8	1.5	-
Attenuation:( Reference level from 0 dB)				
1)500.. $F_C$ -93 MHz dB	50	60	-	-
2) $F_C$ -93... $F_C$ -85 MHz dB	46	53	-	-
3) $F_C$ -85... $F_C$ -68 MHz dB	46	53	-	-
5) $F_C$ -88 MHz dB	50	55	-	-
6) $F_C$ -72 MHz dB	48	65	-	-
7) $F_C$ -44 MHz dB	50	54	-	-
8) $F_C$ -36 MHz dB	46	62	-	-
9) $F_C$ +70...2000 MHz dB	50	61	-	-
Group delay ripple(p-p) ( 1216~1224MHz) nS	-	40	-	-

### C. Measurement Circuit:

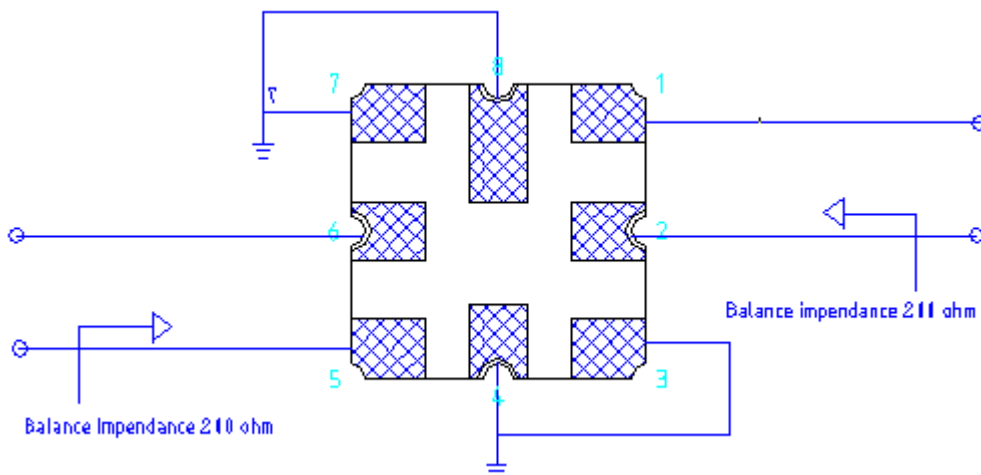

C

## D. Frequency Characteristics :

### 1. Sdd21 Response

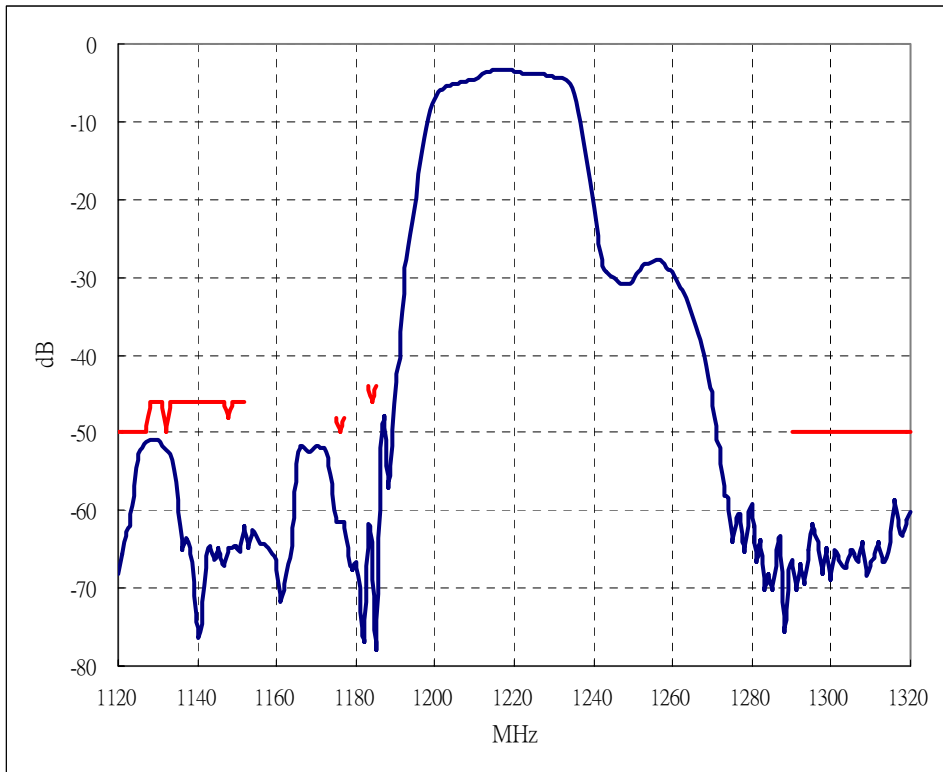

### 2. Sdd21 Response (Passband)

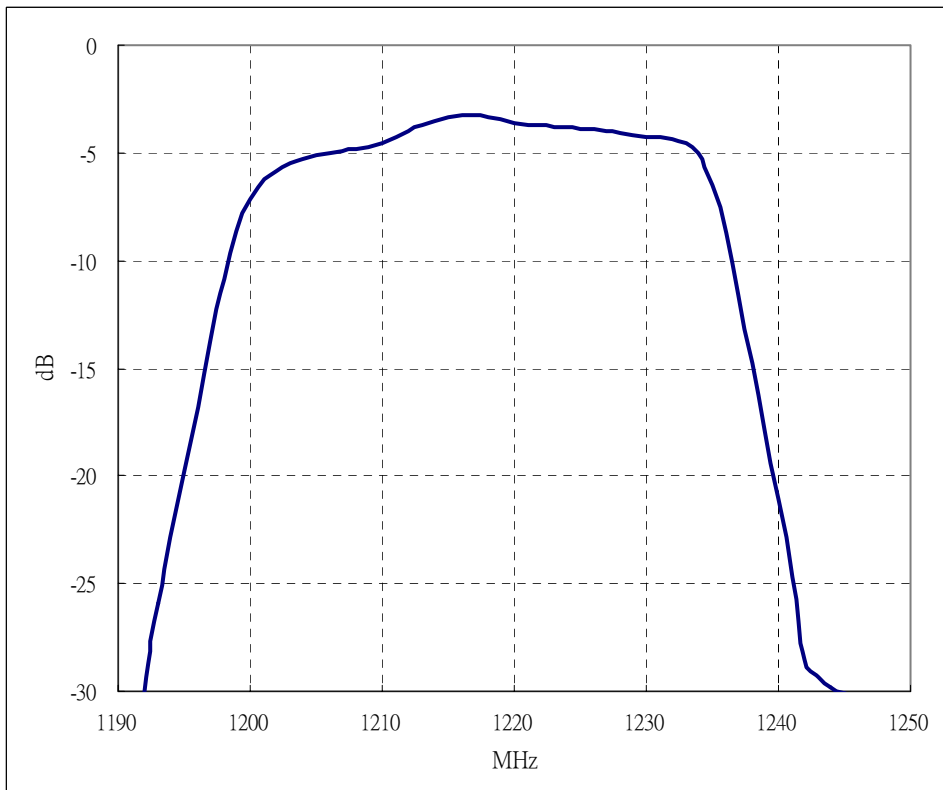

### 3. Sdd21 Response (wide band)

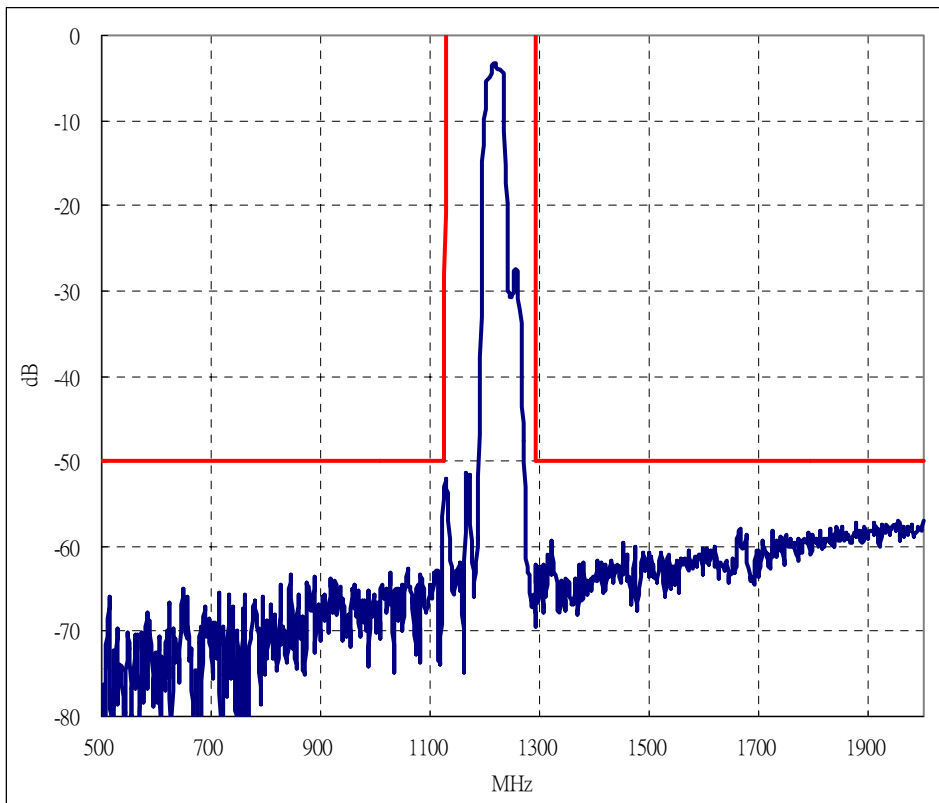

### E. Outline Drawing:

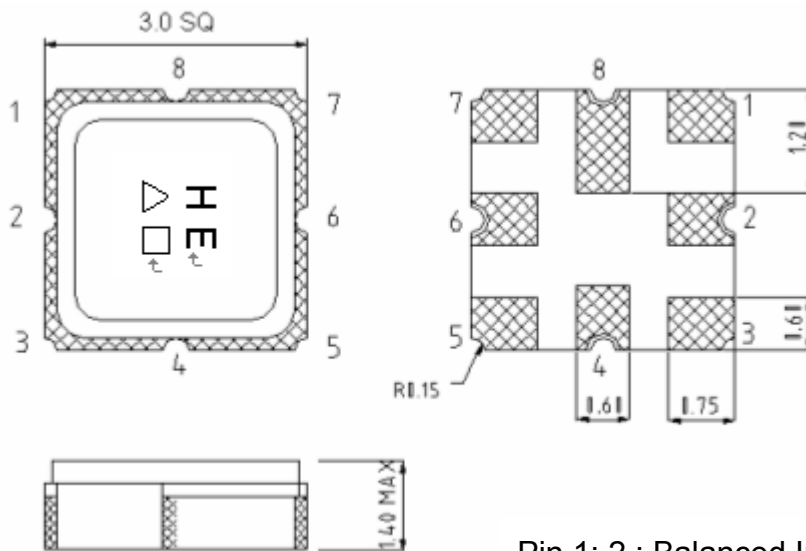

- Pin 1; 2 : Balanced Input
- Pin 5, 6 : Balanced Output
- P3,4,7,8 : Ground
- △ : Year Code
- : Date Code
- Unit : mm

### F. PCB FOOTPRINT:

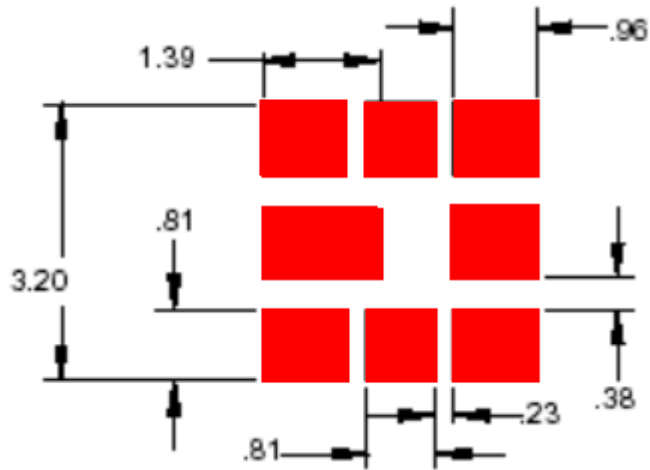

**G. PACKING:**

1. REEL DIMENSION

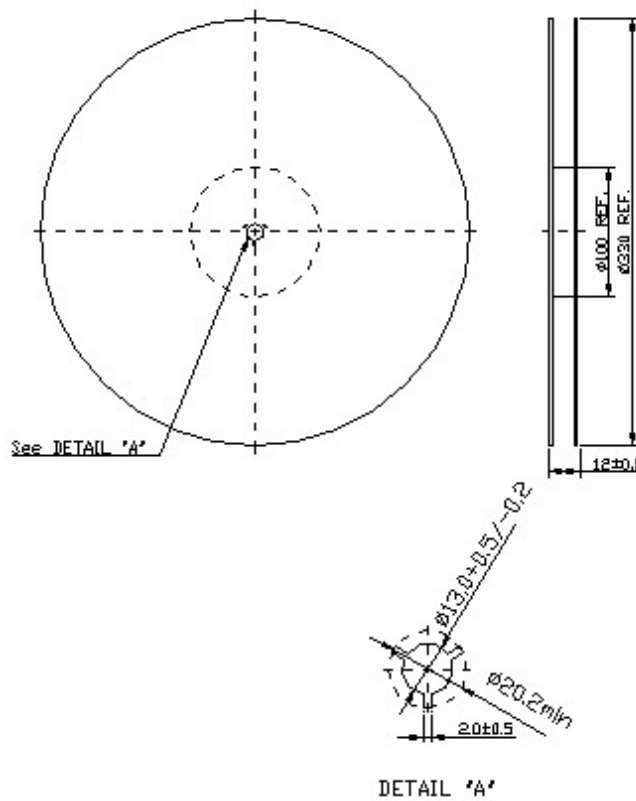

2. TAPE DIMENSION

