

ITEM:

① INSULATOR
POLYTETRAFLUOROETHYLENE
(TFE TEFLON)

② CONTACT
50 MICROINCHES MIN,
GOLD OVER 150 MICROINCHES
MIN, NICKEL ON BERYLLIUM
COPPER

③ BODY
50 MICROINCHES MIN,
GOLD OVER COPPER
ON BRASS

1. ORDER UNDER CATALOG NO 121-24662.
MATES WITH CATALOG NO 121-24672.

2. FOR DIMS. NOT SHOWN SEE MIL-C-39012
SERIES SMC.

③ IDENTIFICATION MARKING:
WINCHESTER ELECTRONICS LOGO,
AND DATE CODE TO BE MARKED
IN APPROXIMATE LOCATION SHOWN.

4. CONNECTOR TEMPERATURE RANGE:
- OPERATING: -40°C to 85°C
- STORING: -55°C to 100°C

5. CONNECTOR ELECTRICAL RATINGS:
- IMPEDANCE: 50Ω, NOM.
- FREQUENCY: 0 to 10 GHz
- VSWR: 1.3 MAX (0 to 4 GHz)
- VOLTAGE: 500 VOLTS, PEAK
- DIELECTRIC: 1.5 kV, RMS

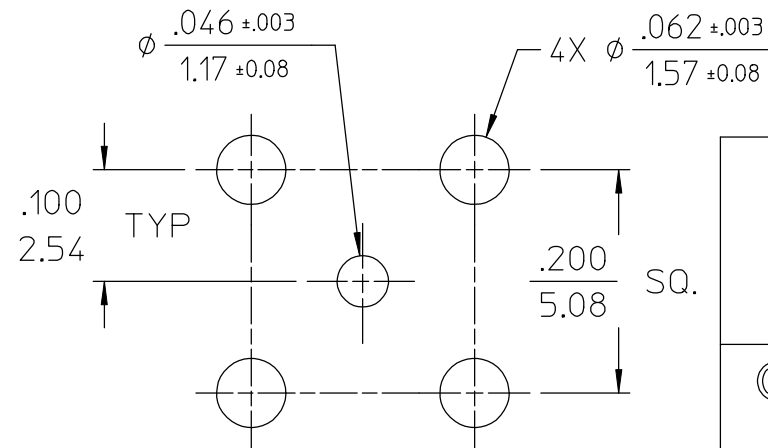
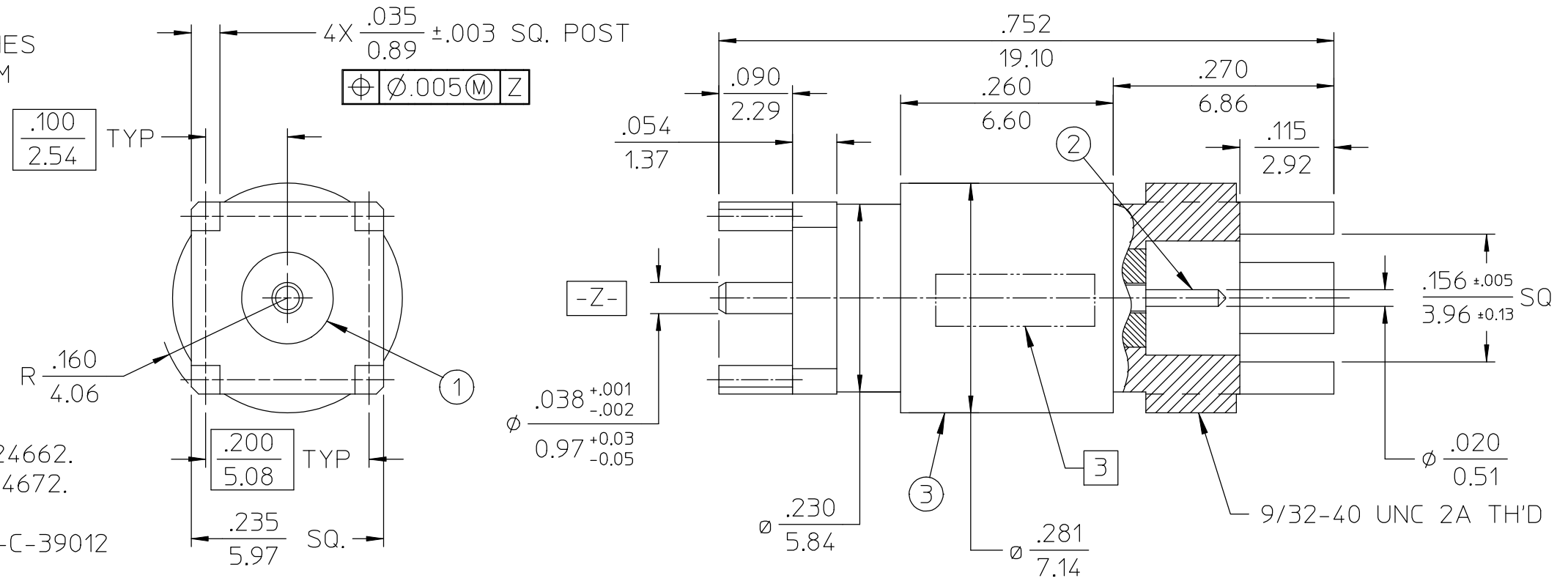

RECOMMENDED P.C.
BOARD HOLE PATTERN

REV	DESCRIPTION	BY DATE	APPD
H	ADDED ±.005 TO .156 SQ. DIM. PER ECR NO 3634	BONESSI 05/09/95	LAW

UNLESS OTHERWISE SPECIFIED: DIMENSIONS ARE IN INCHES, OR INCHES / MM		Litton	
TOLERANCES DECIMALS .xx ± .02/0.5 .xxx ± .007/0.18 ANGLES ± 1° SCALE: 6:1		Winchester Electronics 400 PARK ROAD WATERTOWN, CONNECTICUT 06795	
CUSTOMER DRAWING		TITLE SMC - STRAIGHT JACK P.C. MOUNT (□ KEY)	
DRAWN J.M.G. 11/04/92	DATE	CHECKED	DATE
APPROVED LAW 12/14/92	DATE	APPROVED	DATE
B	24662	SHT. 1 OF 1	REV. H