

**Features:**

- Universal AC input/ Full range
- Wide Operating Ambient Temperature (-20°C~60°C)
- High Efficiency, and High Reliability
- Ultra-minature size, low profile
- Output Protections: OLP/OVP/SCP
- All using 105°C long life electrolytic capacitors.
- 100% full load burn-in test



Model	QPS-20-5	QPS-20-12	QPS-20-15	QPS-20-24	QPS-20-48
<b>Output Characteristics</b>					
DC Output	5V	12V	15V	24V	48V
Rated Current	4A	1.67A	1.34A	0.84A	0.42A
Current Range	0~4A	0~1.67A	0~1.34A	0~0.84A	0~0.42A
Ripple and Noise	0~50°C	50mV	120mV	100mV	100mV
	-10~0°C	75mV	120mV	100mV	100mV
Voltage ADJ. Range	±10% of rated output voltage				
Voltage Accuracy	±2.0%	±2.0%	±2.0%	±2.0%	±2.0%
Line Regulation	±0.5%	±0.5%	±0.5%	±0.5%	±0.5%
Load Regulation	±2.0%	±2.0%	±2.0%	±2.0%	±2.0%
Set-up Time	<2.0s (115VAC input, full load); <1.0s (230VAC input, full load)				
Hold-up Time	>10ms (115VAC input, full load); >20ms (230VAC input, full load)				
Temperature Coefficient	±0.03%/°C				
Overshoot and Undershoot	<5.0%				
<b>Input Characteristics</b>					
Voltage Range	85VAC~264VAC				
Frequency Range	47Hz-63Hz				
Efficiency (Typical)	115VAC Input	72%	78%	80%	78%
	230VAC Input	72%	78%	80%	76%
AC Current (max)	0.5A	0.5A	0.5A	0.5A	0.5A
Inrush Current (Typical)	20A@115VAC Cold start 40A@230VAC Cold start				
Leakage Current	Input-Output: <0.35mA Input-PG: <0.75mA				
<b>Protection</b>					
Over Load (OLP)	105%~150% of rated output power, hiccup mode, auto recover				
Over Voltage (OVP)	110%~140% of rated output voltage, constant voltage				
Short Circuit (SCP)	Long-term mode, auto recovery				
<b>Environmental Characteristics</b>					
Operating Amb. Temp. & Hum	-20°C~60°C; 20%~90% RH Non-Condensing				
Storage Temp. & Hum	-40°C~85°C; 10%~95% RH Non-Condensing				
Safety Standards	UL60950-1; EN60950-1: 2006				
Withstand Voltage	Primary-Secondary: 3.0KVAC;≤10mA. Primary-PG: 1.5KVAC;≤10mA. Secondary-PG: 0.5KVDC;≤10mA				
Isolation Resistance	≥100M ohms				
EMI Conduction & Radiation	Compliance to EN55022(CISPR22) Class B				
Harmonic Current	Compliance to EN61000-3-2, 17625.1-2003				
EMS Immunity	Compliance to EN61000-4-2, 3, 4, 5, 6, 8, 11; ENV50204, light industry level, criteria A				
<b>General Characteristics</b>					
MTBF (MIL-HDBK-217F)	More than 100,000Hrs (25°C, Full load)				
Dimension (LxWxH)	89x51x20mm				
Packing	60PCS/CTN. G.W: 7.6kgs				
Cooling Method	Cooling by free air convection				

## MECHANICAL SPECIFICATIONS

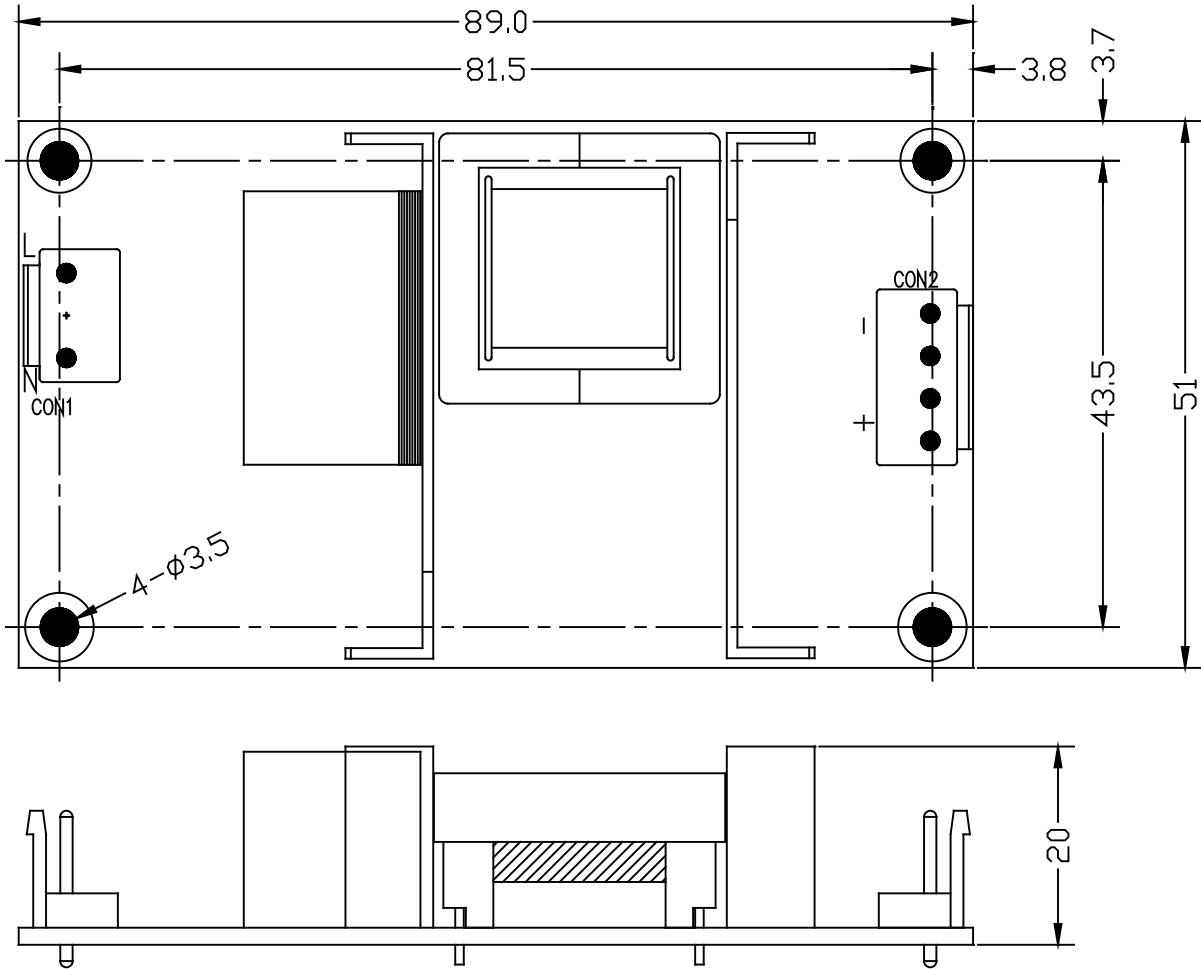

ITEM	CONNECTOR	MATING HOUSING	TERMINAL
AC IN (CON1)	LANDWIN 3961P0300T (CENTER PIN REMOVED)	LANDWIN 3960S OR JST VHR	LANDWIN 3963T011R OR JST SVH-21T-P1.1
DC OUT (CON2)	LANDWIN 3961P0400T		

UNIT: mm