



Part Number	Package	Application	Last Modified
802-RF958.5M-A	3.0 x 3.0 SMD	Wireless	Mar. 2, 2007

TYPE :  
Wireless, RF SAW Filter



PART NUMBER :  
**802-RF958.5M-A**

**OPERATING CONDITIONS / ELECTRICAL CHARACTERISTICS**

PARAMETERS	Condition	Minimum	Typical	Maximum	Units
Center Frequency (Fo)	-	-	958.5	-	MHz
Maximum Insertion Loss	935.5~ 936.5 MHz	-	2.8	3.5	dB
Attenuation:	D.C.~ 45.0 MHz	45	55	-	dB
	Fo+70.0~ Fo+500.0 MHz	50	60	-	
Source Impedance (single ended)*	-	-	50	-	ohm
Load Impedance (single ended)*	-	-	50	-	ohm
Amplitude Ripple	935.5~ 936.5 MHz	-	0.5	1.0	dBp-p
VSWR	935.5~ 936.5 MHz	-	1.5	2.0	-
Maximum DC Voltage	-	-	-	0	V
Maximum Input Power	-	-	-	10	dBm
Operating Temperature	-	-30	-	+65	°C

\* No Matching Network(Ref. Testing Enviroment Circuit as shown below)

**PACKAGE OUTLINE (mm)**

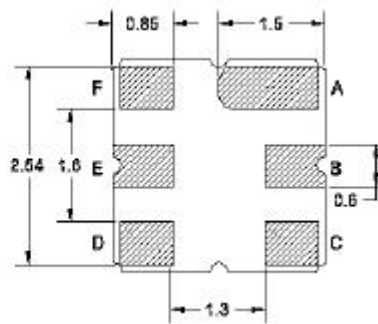
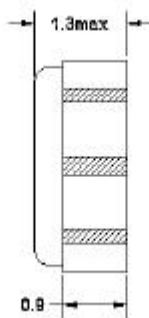
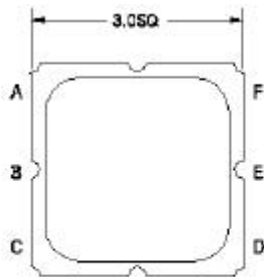

PIN LAYOUT	
A	Ground
B	Out
C	Ground
D	Ground
E	In
F	Ground

**TEST FIXTURE**

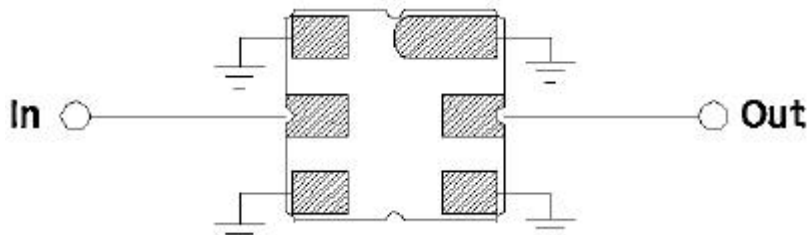

Load/ Source Impedance = 50 ohms

## FREQUENCY RESPONSE

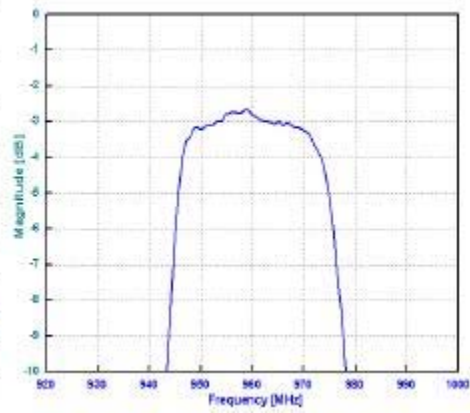
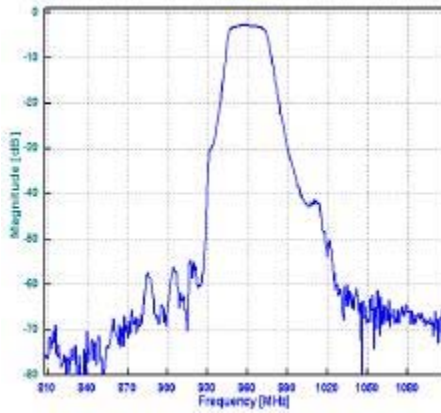

## VSWR

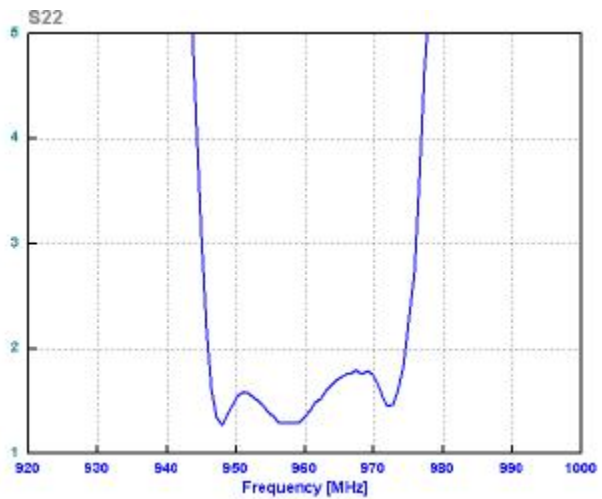
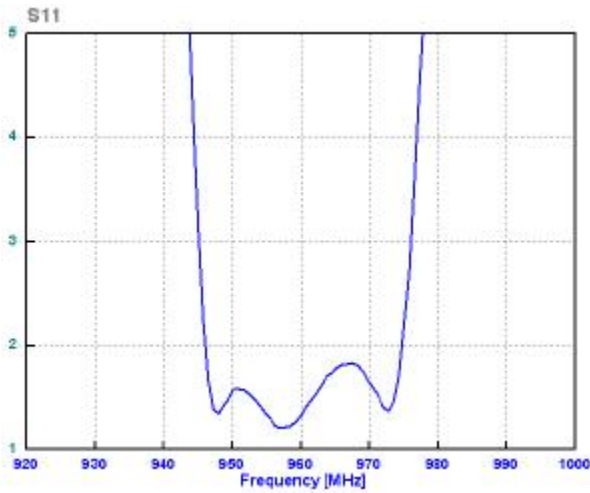

## SMITH CHART

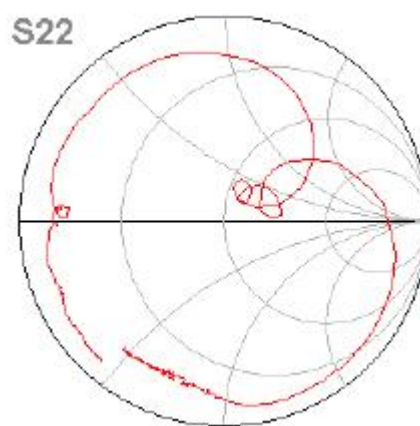
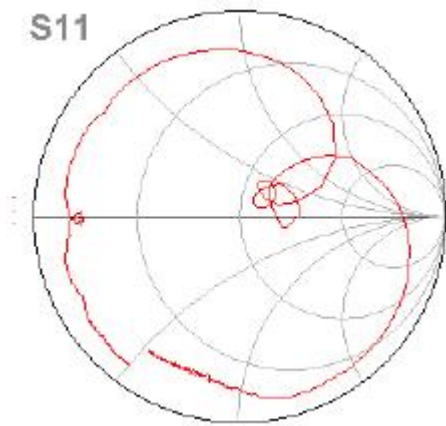

**Oscilent Corporation** - CALL **949.252.0522**

18195 East McDermott Street, Building D, Irvine, CA 92614, USA  
Fax: 949.252.0599, E-Mail: Sales@Oscilent.com

**Part No.:** 802-RF958.5M-A