

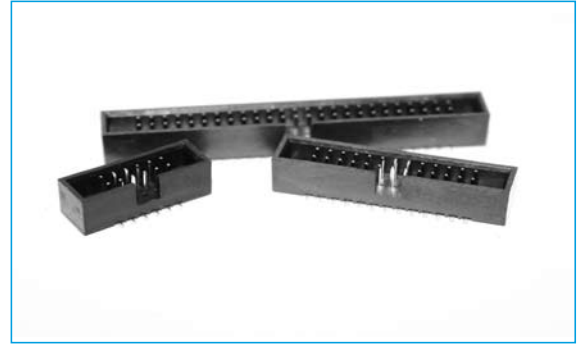

IDC

BOX HEADER SMT 1.27mm

- Industry compatible
- Competitively priced
- Various Plating contacts available
- 1.27mm pitch



SPECIFICATION

Material & Finish

- Contact Material:** Phosphor Bronze
- Insulator Material:** Nylon 6T, glass reinforced, rated UL 94V-0
- Current Rating:** 1 Amp
- Contact Resistance:** 30M Ω Max.
- Insulator Resistance:** 1000M Ω Min.
- Dielectric Withstanding Voltage:** 250V AC for One Minute
- Operating Temperature:** -40°C to + 105°C

| Position | A | B | C |
|----------|-------|-------|-------|
| 10 | 12.51 | 10.85 | 5.08 |
| 12 | 13.78 | 12.12 | 6.35 |
| 14 | 15.05 | 13.39 | 7.62 |
| 16 | 16.32 | 14.66 | 8.89 |
| 20 | 18.86 | 17.20 | 11.43 |
| 22 | 20.13 | 18.47 | 12.70 |
| 26 | 22.67 | 21.01 | 15.24 |
| 30 | 25.21 | 23.55 | 17.78 |
| 34 | 27.75 | 26.09 | 20.32 |
| 40 | 31.56 | 29.90 | 24.13 |
| 44 | 34.10 | 32.44 | 26.67 |
| 50 | 37.91 | 36.25 | 30.48 |

OUTLINE DRAWING

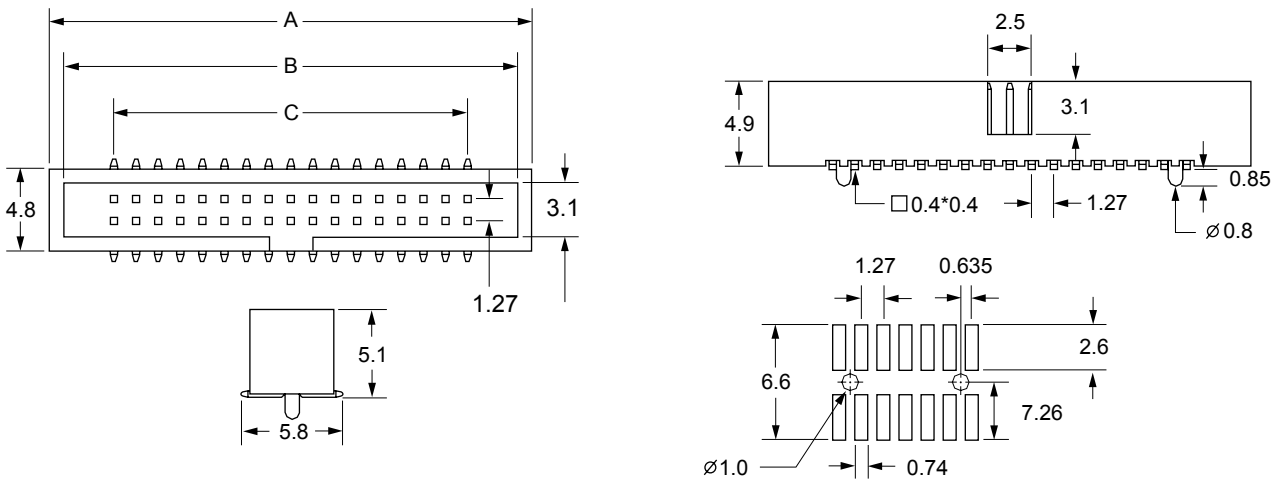

SECTION 15

ORDERING INFORMATION

| DBC | IDC | C44 | 26 | B | G | 1 |
|---------------------|---------------|--------|--|-------------------|---|---------|
| Dubilier Connectors | IDC Connector | Series | N° of Ways | Contact Material | Contact Plating | Colour |
| | | | 10=10way 12=12way 14=14way 20=20way 22=22way | B=Phosphor Bronze | G= Gold Flash S=Selective *=Other Plating available | 1=Black |
| | | | 26=26way 30=30way 34=34way 40=40way 44=44way 50=50way | | | |