

Coaxial

Adapter, SMA-F to SMA-F

SF-SF50+

50Ω

DC to 18 GHz



Maximum Ratings

Operating Temperature	-55°C to 100°C
Storage Temperature	-55°C to 100°C

Features

- flat response
- excellent VSWR, 1.10:1 typ. up to 12.4 GHz and 1.15:1 typ. up to 18 GHz
- low cost adapters, available from stock
- rugged stainless steel body, gold plated

CASE STYLE: DJ952

Connectors	Model	Price	Qty.
Conn1 SMA-F	Conn2 SMA-F SF-SF50+	\$4.95 ea.	(1-24)

+ RoHS compliant in accordance with EU Directive (2002/95/EC)

The +Suffix has been added in order to identify RoHS Compliance. See our web site for RoHS Compliance methodologies and qualifications.

Applications

- interconnection of RF cables and equipment

Electrical Specifications T_{AMB}=25 °C

FREQUENCY (GHz)	INSERTION LOSS (dB)	VSWR (:1) Max.		
		DC-8 GHz	DC-12.4 GHz	DC-18 GHz
f _L -f _U	Typ.			
DC-18	0.1	1.15	1.25	1.40

Outline Drawing

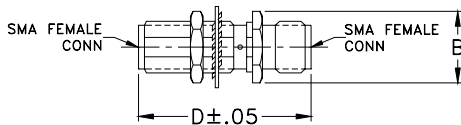

Outline Dimensions (inch/mm)

B	D	F	G	H	J	K	wt
.36	.87	.312	.230	.050	.575	.312	grams
9.14	22.10	7.92	5.84	1.27	14.61	7.92	3.6

Typical Performance Data

Frequency (MHz)	Insertion Loss (dB)	VSWR (:1)	
		SMA-F	SMA-F
10.00	0.01	1.01	1.00
50.00	0.01	1.00	1.00
100.00	0.01	1.01	1.01
500.00	0.04	1.01	1.01
1000.00	0.05	1.01	1.01
2000.00	0.06	1.01	1.01
3000.00	0.07	1.01	1.00
4000.00	0.08	1.03	1.03
5000.00	0.09	1.07	1.06
6000.00	0.09	1.09	1.08
7000.00	0.09	1.09	1.08
8000.00	0.09	1.07	1.05
9000.00	0.09	1.07	1.06
10000.00	0.11	1.11	1.12
11000.00	0.12	1.16	1.18
12000.00	0.13	1.19	1.20
13000.00	0.13	1.15	1.18
15000.00	0.12	1.08	1.09
17000.00	0.20	1.29	1.29
18000.00	0.24	1.34	1.35

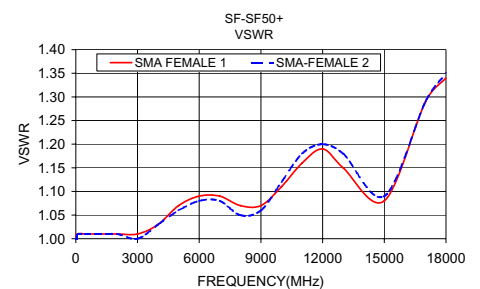
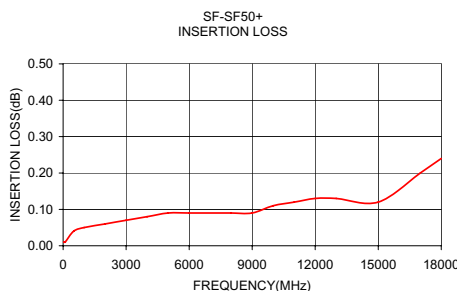

P.O. Box 350166, Brooklyn, New York 11235-0003 (718) 934-4500 Fax (718) 332-4661 For detailed performance specs & shopping online see Mini-Circuits web site



The Design Engineers Search Engine Provides ACTUAL Data Instantly From MINI-CIRCUITS At: www.minicircuits.com

RF/IF MICROWAVE COMPONENTS

REV. A
M98898
SF-SF50+
ED-10311
YB/CP
071129