



# CHENMKO ENTERPRISE CO.,LTD

**CH521G-30PT**

## SURFACE MOUNT

SCHOTTKY BARRIER DIODE

VOLTAGE 30 Volts CURRENT 0.2 Ampere

Lead free devices

### APPLICATION

\* Low current rectification and high speed switching

### FEATURE

- \* Extremely small surface mounting type. (SOD-723)
- \*  $I_o=200mA$  guaranteed despite size
- \* Low VF. (VF=0.40V Typ. at 200mA)

### CONSTRUCTION

\* Silicon epitaxial planar

### MARKING

\* 3



SOD-723

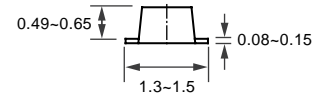
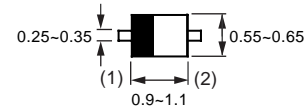

Dimensions in millimeters

SOD-723

### CIRCUIT

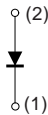

### MAXIMUM RATINGS ( At TA = 25°C unless otherwise noted )

| RATINGS                                                      | SYMBOL | CH521G-30PT | UNITS |
|--------------------------------------------------------------|--------|-------------|-------|
| Maximum Recurrent Peak Reverse Voltage                       | VRRM   | 30          | Volts |
| Maximum RMS Voltage                                          | VRMS   | 21          | Volts |
| Maximum DC Blocking Voltage                                  | VDC    | 30          | Volts |
| Maximum Average Forward Rectified Current                    | $I_o$  | 0.2         | Amps  |
| Peak Forward Surge Current at 8.3 mSec single half sine-wave | IFSM   | 1.0         | Amps  |
| Typical Junction Capacitance between Terminal (Note 1)       | CJ     | 6.0         | pF    |
| Maximum Operating Temperature Range                          | TJ     | +125        | °C    |
| Storage Temperature Range                                    | TSTG   | -40 to +125 | °C    |

### ELECTRICAL CHARACTERISTICS ( At TA = 25°C unless otherwise noted )

| CHARACTERISTICS                                      | SYMBOL | CH521G-30PT | UNITS |
|------------------------------------------------------|--------|-------------|-------|
| Maximum Instantaneous Forward Voltage at $I_f=200mA$ | VF     | 0.50        | Volts |
| Maximum Average Reverse Current at $V_R=10V$         | IR     | 30.0        | uAmps |

NOTES : 1. Measured at 1.0 MHz and applied reverse voltage of 10 volts.  
 2. ESD sensitive product handling required.

2002-5

## RATING CHARACTERISTIC CURVES ( CH521G-30PT )

FIG. 1 - FORWARD CHARACTERISTICS

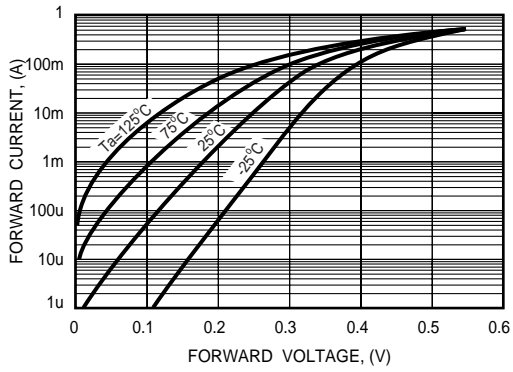

FIG. 2 - REVERSE CHARACTERISTICS

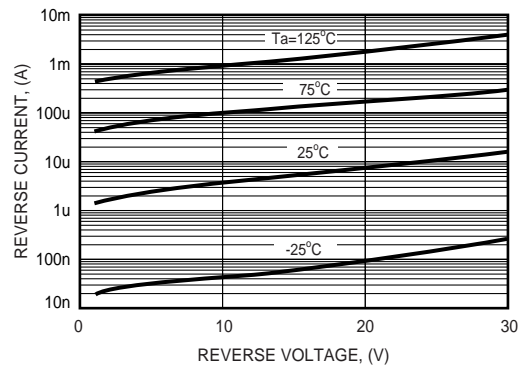

FIG. 3 - TYPICAL JUNCTION CAPACITANCE

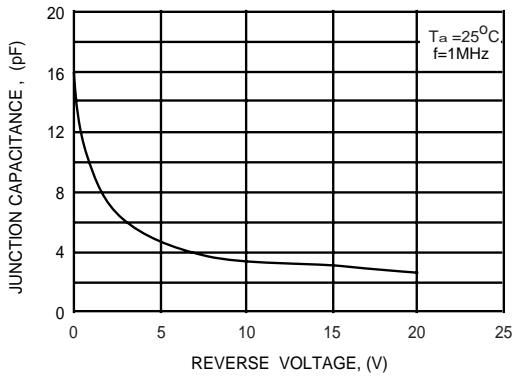

FIG. 4 - TYPICAL FORWARD CURRENT DERATING CURVE

