

P-tec Corp. Tel:(800)688-0613  
 2405 Commerce Circle Tel:(719) 589 3122  
 Alamosa Co. 81101 Fax:(719) 589 3592  
 www.p-tec.net sales@p-tec.net



## PL00250 Series SMD LED 1206 Package

### Features

- \*Round Dome Lens Package 3.2 x 1.6 x 1.8mm
- \*AlGaInP Ultra Bright Amber Chip used
- \*Narrow Viewing Angle
- \*Low Current Requirements
- \*High Light Output
- \*Compatible with IR Solder-Process
- \*Industry Standard Footprint
- \*2000 or 1000 pcs per Reel
- \*RoHS Compliant

### Absolute Maximum Ratings at T<sub>A</sub> = 25°C

Power Dissipation.....	72mW
Reverse Voltage (<100µA) .....	5.0V
Max Forward Current .....	30mA
Peak Forward Current (1/10 Duty Cycle, 0.1ms Pulse Width).....	150mA
Operating Temperature Range .....	-40°C to +85°C
Storage Temperature Range .....	-40°C to +85°C
Reflow Soldering Temperature.....	260°C for 10 seconds

### Electrical & Optical Characteristics at T<sub>A</sub> = 25°C

Part Number	Emitting Color	Chip Material	Peak Wave Length	Dominant Wave Length	Viewing Angle 2θ1/2	Forward Voltage @20mA (V)		Luminous Intensity @20mA (mcd)	
						Typ	Max	Min	Typ
Water Clear Lens			nm	nm	Degrees				
PL00250-WCA03	Amber	AlInGaP	618	610	40°	2.0	2.4	135.0	300.0

Package Dimensions are in **Millimeters**. Tolerance is ± 0.25mm unless otherwise specified.

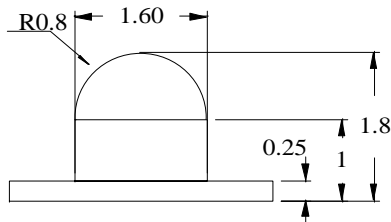
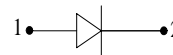
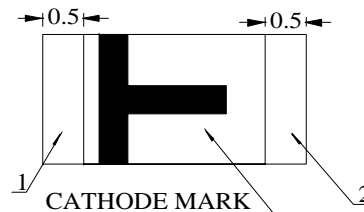
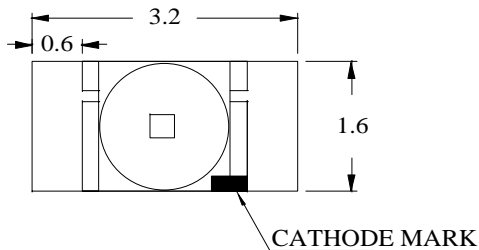

### Recommended Soldering Pad Layout

