



# Frontier Electronics Corp.

667 E. COCHRAN STREET, SIMI VALLEY, CA 93065

TEL: (805) 522-9998 FAX: (805) 522-9989

E-mail: [frontiersales@frontierusa.com](mailto:frontiersales@frontierusa.com)

Web: <http://www.frontierusa.com>

## SMD Air Wound Coils—294A series

### A. Electrical specifications:

Part No.	Turns	L (nH)	Tolerance	Q (min)	Q (Typ)	Test Freq.	DCR (mΩ)	SRF min (MHz)	I DC (A max.)
294A-09	9	90	J, G	95	114	50 MHz	15	1140	3.5
294A-10	10	111	J, G	87	104	50 MHz	15	1020	3.5
294A-11	11	130	J, G	87	104	50 MHz	20	900	3.0
294A-12	12	169	J, G	95	114	50 MHz	25	875	3.0
294A-13	13	206	J, G	95	114	50 MHz	30	800	3.0
294A-14	14	222	J, G	92	110	50 MHz	35	730	3.0
294A-15	15	246	J, G	95	114	50 MHz	35	685	3.0
294A-16	16	307	J, G	95	114	50 MHz	35	660	3.0
294A-17	17	380	J, G	95	114	50 MHz	50	590	2.5
294A-18	18	422	J, G	95	114	50 MHz	60	540	2.5
294A-19	19	491	J, G	95	114	50 MHz	65	535	2.0
294A-20	20	538	J, G	87	104	50 MHz	90	490	2.0

### B. Mechanical dimensions: (Unit: mm)

Series No.	a	b	c	d	e
294A	6.35(MAX)	1.02±0.39	5.9(MAX)	10.55(MAX)	7.98±0.51

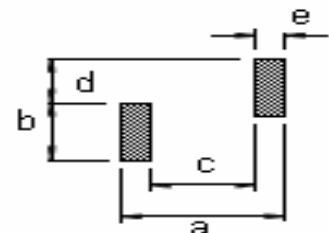
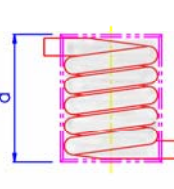
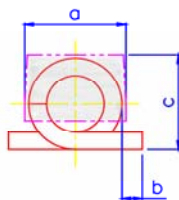
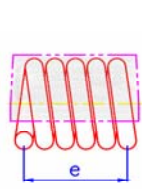
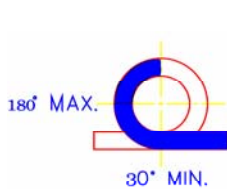

**Mechanical dimension**

**Land Pattern**

### C. Land Pattern: (Unit: mm)

Series No.	a	b	c	d	e
294A	10.0	4.70	5.95	2.42	2.04

### D. Notes:

1. Tolerance: J = ± 5 % or G = ± 2 %.
2. Inductance & Q measured on the HP4291B with HP16193 test fixture.
3. SRF measured on the HP8753E.
4. Operating temp. : -40°C TO +125°C.
5. For Temperature Rise: 15°C.
6. Inductance Range: (@ 25°C.)  
294A: From 90nH to 538nH.
7. Equivalent to Coilcraft's "Maxi Spring" Air Core Inductor.
8. **RoHS** compliant.



# Frontier Electronics Corp.

667 E. COCHRAN STREET, SIMI VALLEY, CA 93065

TEL: (805) 522-9998 FAX: (805) 522-9989

E-mail: [frontiersales@frontierusa.com](mailto:frontiersales@frontierusa.com)

Web: <http://www.frontierusa.com>

## SMD Air Wound Coils—294A series

### E. Characteristic curve:

#### 1. L vs. Frequency:

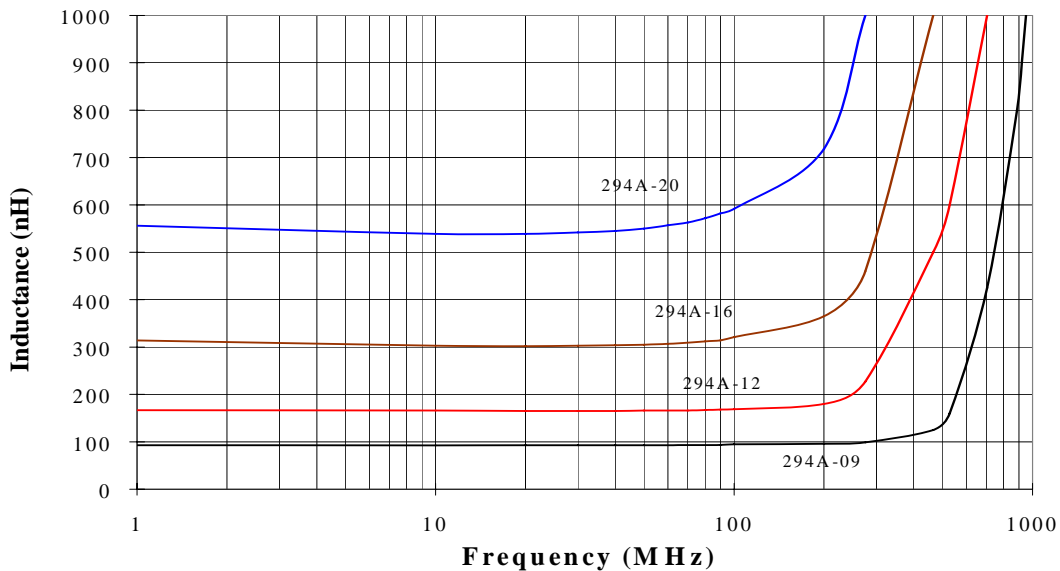

#### 2. Typical Q vs. Frequency:

