

JDM TYPE COAXIAL TERMINAL CONNECTORS

General

The JDM Series are unitized connectors with a shell that is the same size as those of the SM Series. These connectors have a coaxial terminal mounting hole. The coaxial terminal is compatible with a wide range of

requirements, being available in soldering and PCB dip soldering models. The terminal is EMI-resistant and uses a special case.

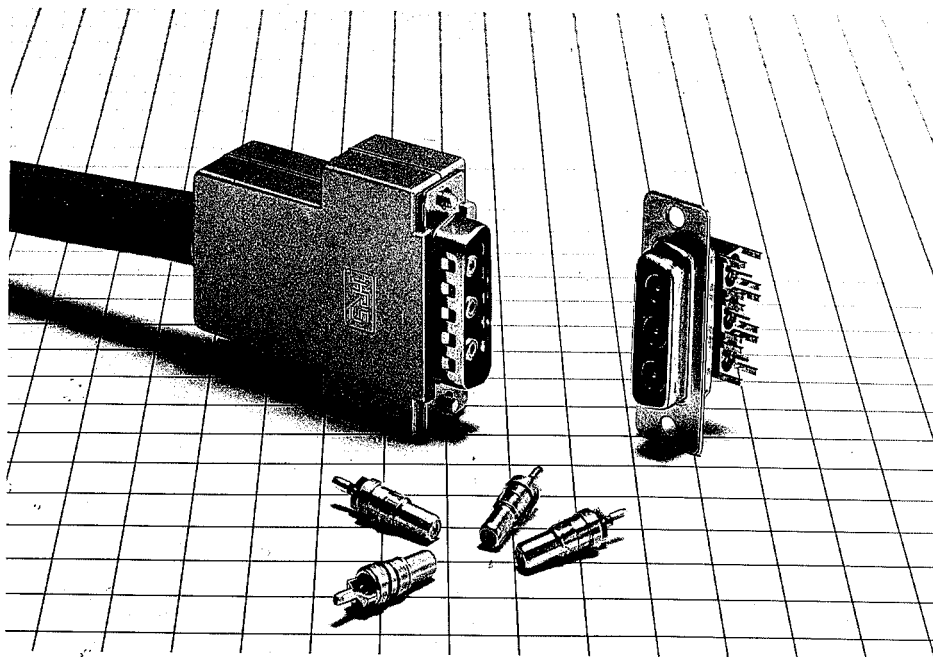

Features

- (1) Compact and sturdy due to metal shell.
- (2) Uses insulation made from highly heat-resistant and chemical-resistant epoxy and PPS resins.
- (3) Available in various types of soldering, such as soldering, straight dip soldering, and right angle dip soldering. The coaxial terminals are compatible with all types of housing.
- (4) EMI-resistant model in a special case available.

Applications

Computers, peripherals and terminals, control equipment, radio equipment and measuring instruments.

Connector Housing

Main Specifications

Description	Material	Finish
Shell	Copper	Treated with dichromate over zinc plating (dimpled connectors are solder or nickel-plated).
Insulator	Epoxy resin, PPS resin	
Male terminal	Brass	Gold-plated
Female terminal	Phosphor bronze	Gold-plated

Item	Standard
Contact resistance	20mV or less at 5A
Current Rating	5A
Insulation resistance	5,000 M Ω or higher at 500VDC
Withstand voltage	AC1250V for one minute

Ordering Information

J **D** * **M** - **7** **W** **2** **P** **F** (0.5)
 Model (Note:1) (Note:2) (Note:3) (Note:4) (Note:5)

Note 1: Shell size.....A,B,C,D,E

Note 2: Terminal arrangement.....The first numeral stands for the number of total contacts, and the last numeral for the number of coaxial terminal mounting holes.

Note 3: Shape of terminal.....P: Male, S: Female

Note 4: Shape of shell.....F-dimpled housing

Note 5: (0.5) Nickel-plated shell

Pin Connector

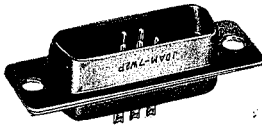

CL211-0016-0
JDAM-7W2P

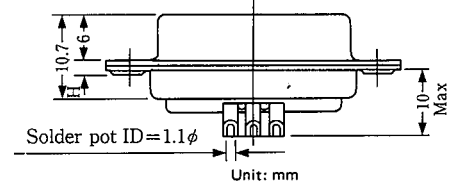
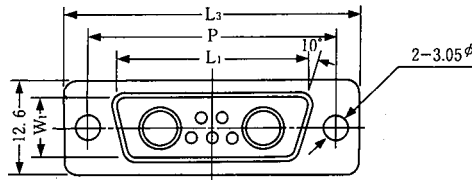

HRS No.	No. of Pin	Part No.	L ₁	L ₂	P	W ₁	H(abt.)
*CL211-0014-5	5	JDEM-5W1P	16.90	30.8	24.99	8.34	1.2
*CL211-0016-0	7	JDAM-7W2P	25.24	38.9	33.32	8.34	1.2
CL211-0027-7	25	JDCM-25W3P	55.47	69.3	63.50	8.40	1.6
CL211-0117-8	27	JDCM-27W2P	55.47	69.3	63.50	8.40	1.6
CL211-0727-5	3	JDAMA-3W3PF	25.24	38.9	33.32	8.34	1.2

* standard See page 52 for terminal arrangement and mounting hole dimensions.

Socket Connector

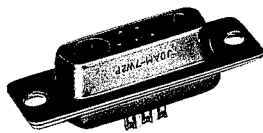

CL211-0017-3
JDAM-7W2S

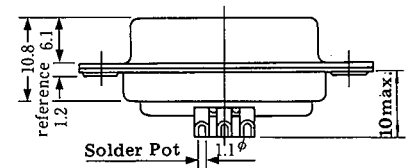
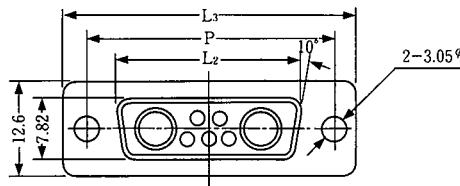

Float Mounts

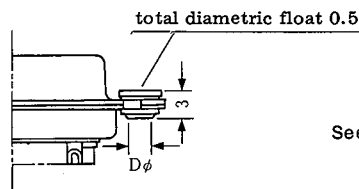

HRS No.	No. of Pin	Part No.	L ₂	L ₃	P
*CL211-0015-8	5	JDEM-5W1S	16.4	30.8	24.99
*CL211-0017-3	7	JDAM-7W2S	24.59	38.9	33.32
CL211-0028-0	25	JDCM-25W3S	54.76	69.3	63.50
CL211-0787-0	3	JDAMB-3W3S	24.59	38.9	33.32

See page 44 for terminal arrangement and mounting hole dimensions.

Floating type

HRS No.	No. of Pin	Part No.	L ₂	L ₃	P	D phi
CL211-0048-7	5	JDEMF-5W1S	16.26	30.8	24.99	2.18
CL211-0049-0	7	JDAMF-7W2S	24.59	39.1	33.32	2.18
CL211-0052-4	25	JDCMF-25W3S	54.76	69.3	63.50	2.0
CL211-0118-0	27	JDCMF-27W2S	54.76	69.3	63.50	2.0

See page 52 for terminal arrangement and mounting hole dimensions.

Coaxial Contacts

The coaxial terminal for the JDM Series connectors are described below. When ordering, specify the models meeting your application requirements.

Mount these coaxial terminals from the connector wiring connection side because they are of snap-in type.

Electrical and Environmental

Component	Material	Finish
P Shell	Brass	Gold-plated
R shell	Phosphor bronze	Gold-plated
Insulation	Tetrafluoride resin	
Male terminal	Brass	Gold-plated
Female terminal	Phosphor bronze	Gold-plated

Item	Standard	
Contact resistance	5A, 20mV or less	
Insulation resistance	500 VDC, 5,000 MΩ or more	
Withstand voltage	Model SS	1,000 VDC for 1 min.
	Model RS	800 VDC for 1 min.

Straight Soldering Type

Unit: mm

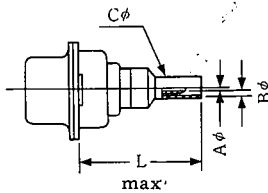

HRS No.	Part No.	L (max)	φ A	φ B	φ C	Applicable cable	Applicable connector
CL211-0033-0	JDM-CP-SS	15.9	1.02	2.4	1.5	RG-196/U	JD「」-W「」P (Male connector)
CL211-0071-9	JDM-CP-SS2	20.2	2.6	4.5	2.5	2.5C-2V	
CL211-0126-9	JDM-CP-SS4	15.8	1.7	3.1	1.5	RG- ^{187/7} / _{188/U}	
CL211-0150-3	JDM-CP-SS11	15.8	1.7	3.6	2	1.5C-2V	
CL211-0813-9	JDM-CP-SS12	15.8	1.7	3.8	1.5	1.5D-QEW	
CL211-0034-2	JDM-CR-SS	15.9	1.02	2.4	1.5	RG-196/U	JD「」-W「」S (Female connector)
CL211-0054-0	JDM-CR-SS2	20.2	2.6	4.5	2.5	2.5C-2V	
CL211-0127-1	JDM-CR-SS4	15.9	1.7	3.1	1.5	RG- ^{187/U} / _{188/U}	
CL211-0756-7	JDM-CR-SS11	15.9	1.8	3.5	1.5	1.5C-2V	
CL211-0798-7	JDM-CR-SS12	15.9	1.7	3.8	1.5	1.5D-QEW	

Right Angle Soldering Type

Unit: mm

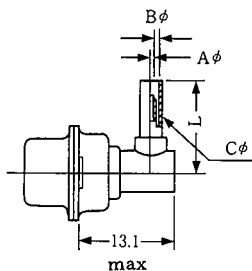

HRS No.	Part No.	L	φ A	φ B	φ C	Applicable cable	Applicable connector
CL211-0035-5	JDM-CP-RS	12.5	1.02	2.4	1.5	RG-196/U	JD「」-W「」P (Male connector)
CL211-0055-2	JDM-CP-RS2	1.50	2.6	4.5	2.5	2.5C-2V	
CL211-0080-0	JDM-CP-RS4	15.0	1.7	3.1	1.5	RG- ^{187/U} / _{188/U}	
CL211-0070-6	JDM-CR-RS2	15.0	2.6	4.5	2.5	2.5C-2V	JD「」-W「」S (Female connector)
CL211-0116-5	JDM-CR-RS6	15.0	3.2	5.2	2.5	RG-58/U	

Extraction Tool of Coaxial Contacts

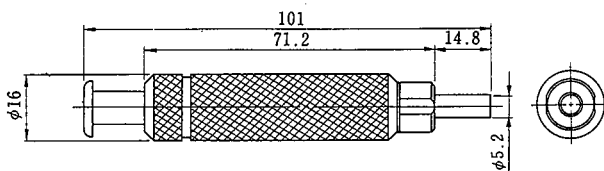

HRS No.	Part No.
CL211-0056-5	JDM-T

Straight Dip Type

JDAMB-3W3S

JDM-CR-SSD
CL211-0806-3

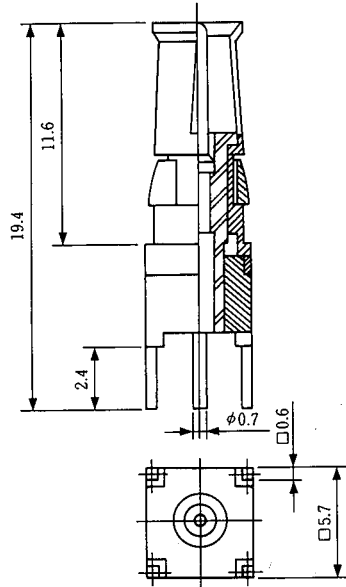

DM-CR-SSD backboard dimensions
(JDAMB-3W3S)

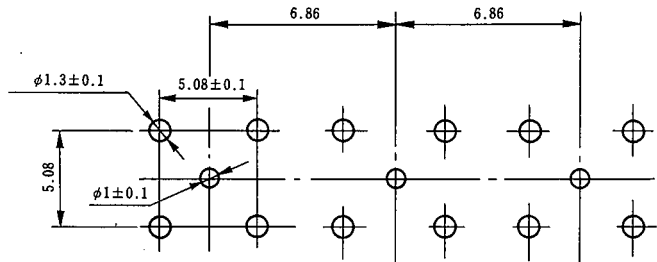

Right-angle Dip Type

JDAMB-3W3S

JDM-CR-RSD
CL211-0776-4

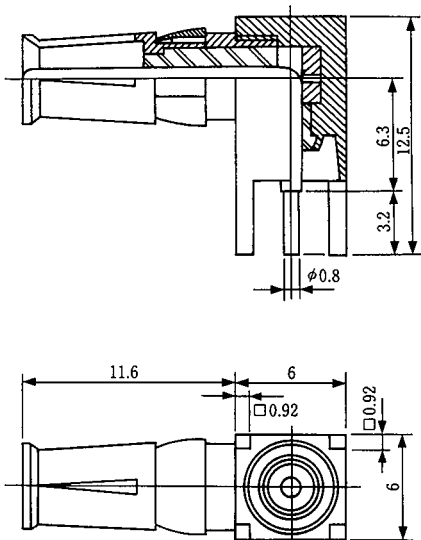

JDM-CR-RSD backboard dimensions
(JDAMB-3W3S)

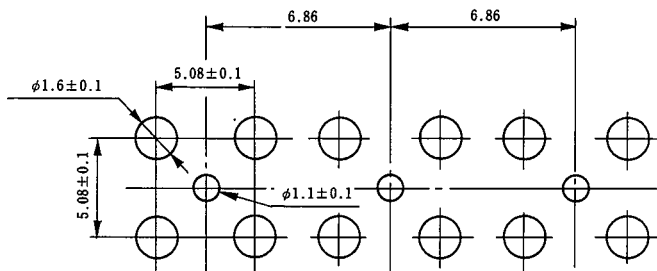

Plug Case

Main Material

Description	Material	Finish
Plug case	Zinc alloy die casting	Painted in silver

Ordering Information

$\frac{H}{(1)} \frac{D}{(2)} \frac{A}{(3)} - \frac{C}{(3)} \frac{T}{(3)} \frac{H}{(4)} \frac{A}{(4)}$

- (1) Sign for connector
- (2) Connector size: A (15 contacts)
- (3) Sign for type of plug case
CT: Plug case with a vertical cable inlet opening
- (4) Serial sign for type of plug case
HA: Zinc alloy die casting, painted in silver

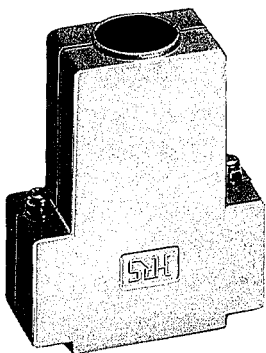

CL211-0729-4
HDA-CTHA

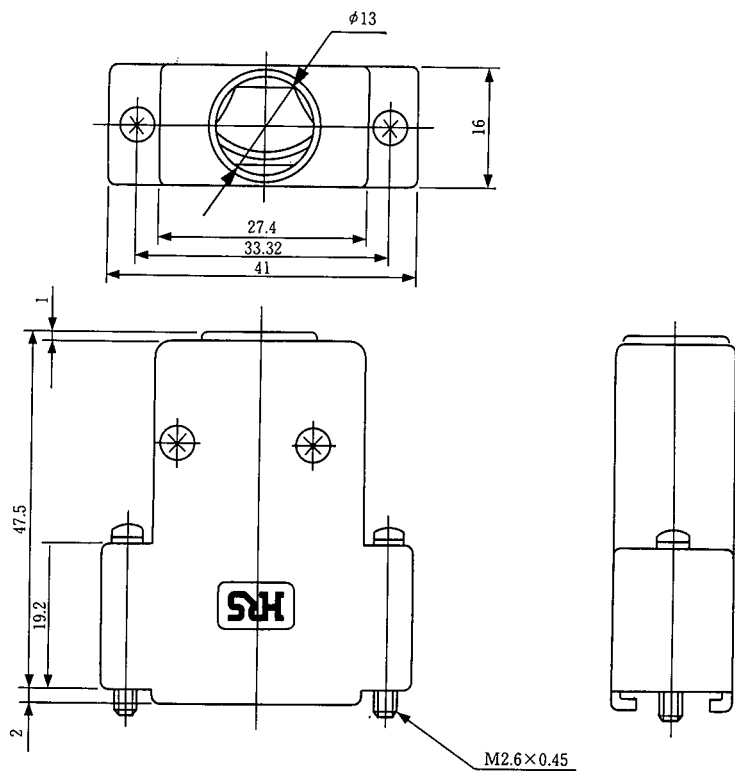

JDM Connector Terminal Arrangement

The terminal numbers illustrated below are as viewed from the mating face with the P (male) unit.

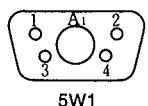
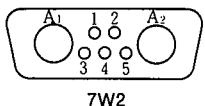
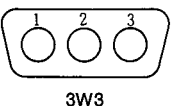
contact arrangement			
shell size	E	A	A
No. of Pin	4	5	3
contact cavity	1	2	3

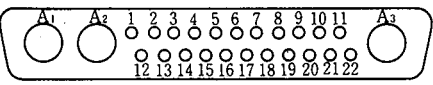
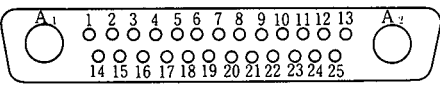
contact arrangement		
shell size	C	C
No. of Pin	22	25
contact cavity	3	2

* Order coaxial terminals separately from the connectors. For coaxial terminals, see page. 49

SM Series Mounting Hole Dimensions

Unit: mm

shell size	a	b
E	24.99	20.2
A	33.32	28.6
B	47.04	42.3
C	63.50	58.7

