

# Central<sup>TM</sup> Semiconductor Corp.

145 Adams Avenue, Hauppauge, NY 11788 USA  
Tel: (631) 435-1110 • Fax: (631) 435-1824

Manufacturers of World Class Discrete Semiconductors

1N5615

1N5617

1N5619

1N5621

1N5623

FAST RECOVERY

GLASS PASSIVATED RECTIFIER

1.0 AMPS, 200-1000 VOLTS

GPR-1A CASE

## DESCRIPTION

The CENTRAL SEMICONDUCTOR 1N5615 Series types are Silicon Rectifiers mounted in a hermetically sealed, glass passivated package designed for general applications where Fast Reverse Recovery Times and high reliability is desired.

## MAXIMUM RATINGS ( $T_A=25^\circ\text{C}$ unless otherwise noted)

	SYMBOL	1N5615	1N5617	1N5619	1N5621	1N5623	UNIT
Peak Repetitive Reverse Voltage	$V_{RRM}$	200	400	600	800	1000	V
DC Blocking Voltage	$V_R$	200	400	600	800	1000	V
RMS Reverse Voltage	$V_R(\text{RMS})$	140	280	420	560	700	V
Average Forward Current ( $T_A=55^\circ\text{C}$ )	$I_O$			1.0			A
Peak Forward Surge Current	$I_{FSM}$			50			A
Operating and Storage Junction Temperature	$T_J, T_{stg}$			-65 TO +200			$^\circ\text{C}$

## ELECTRICAL CHARACTERISTICS ( $T_A=25^\circ\text{C}$ unless otherwise noted)

SYMBOL	TEST CONDITIONS	MIN	MAX	UNIT
$I_R$	$V_R$ =Rated $V_{RRM}$		0.5	$\mu\text{A}$
$I_R$	$V_R$ =Rated $V_{RRM}$ , $T_A=100^\circ\text{C}$		25	$\mu\text{A}$
$V_F$	$I_F=1.0\text{A}$		1.2	V
$BV_R$	$I_R=50\mu\text{A}$ (1N5615)	220		V
$BV_R$	$I_R=50\mu\text{A}$ (1N5617)	440		V
$BV_R$	$I_R=50\mu\text{A}$ , (1N5619)	660		V
$BV_R$	$I_R=50\mu\text{A}$ (1N5621)	880		V
$BV_R$	$I_R=50\mu\text{A}$ (1N5623)	1100		V
C	$V_R=12\text{V}$ , $f=130\text{kHz}$		35	pF
$t_{rr}$	$I_F=0.5\text{A}$ , $I_R=1.0\text{A}$ , Recov. to 0.25A (1N5615, 1N5617)		150	ns
$t_{rr}$	$I_F=0.5\text{A}$ , $I_R=1.0\text{A}$ , Recov. to 0.25A (1N5619)		250	ns
$t_{rr}$	$I_F=0.5\text{A}$ , $I_R=1.0\text{A}$ , Recov. to 0.25A (1N5621)		300	ns
$t_{rr}$	$I_F=0.5\text{A}$ , $I_R=1.0\text{A}$ , Recov. to 0.25A (1N5623)		500	ns

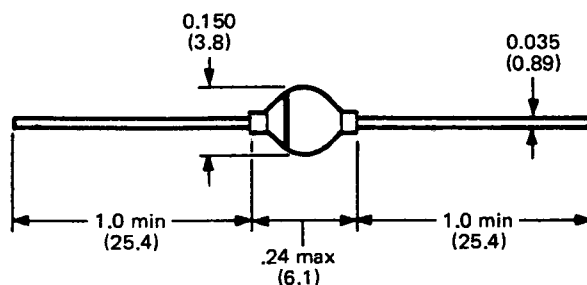

DIMENSIONS IN INCHES (MILLIMETERS)

This datasheet has been download from:

[www.datasheetcatalog.com](http://www.datasheetcatalog.com)

Datasheets for electronics components.